

INDUSTRIAL FOR LEASE
2113-2115 DABNEY ROAD
RICHMOND, VIRGINIA 23230



PROPERTY FEATURES

- **2,875 - 5,750 SF AVAILABLE**
- Great exposure on Dabney Road
- Convenient access to I-64 & I-95
- M-1 Zoning

**AVAILABLE
NOW**



**CUSHMAN &
WAKEFIELD**

THALHIMER

PROPERTY HIGHLIGHTS

SPACE AVAILABLE: SUITE 2113-2115

Availability:	2,875 - 5,750 SF
Loading:	2 loading docks
Timing:	Available now
Clear Height:	15'
Lease Rate:	\$11.00 PSF, NNN



REAR OF THE BUILDING

FLOORPLANS

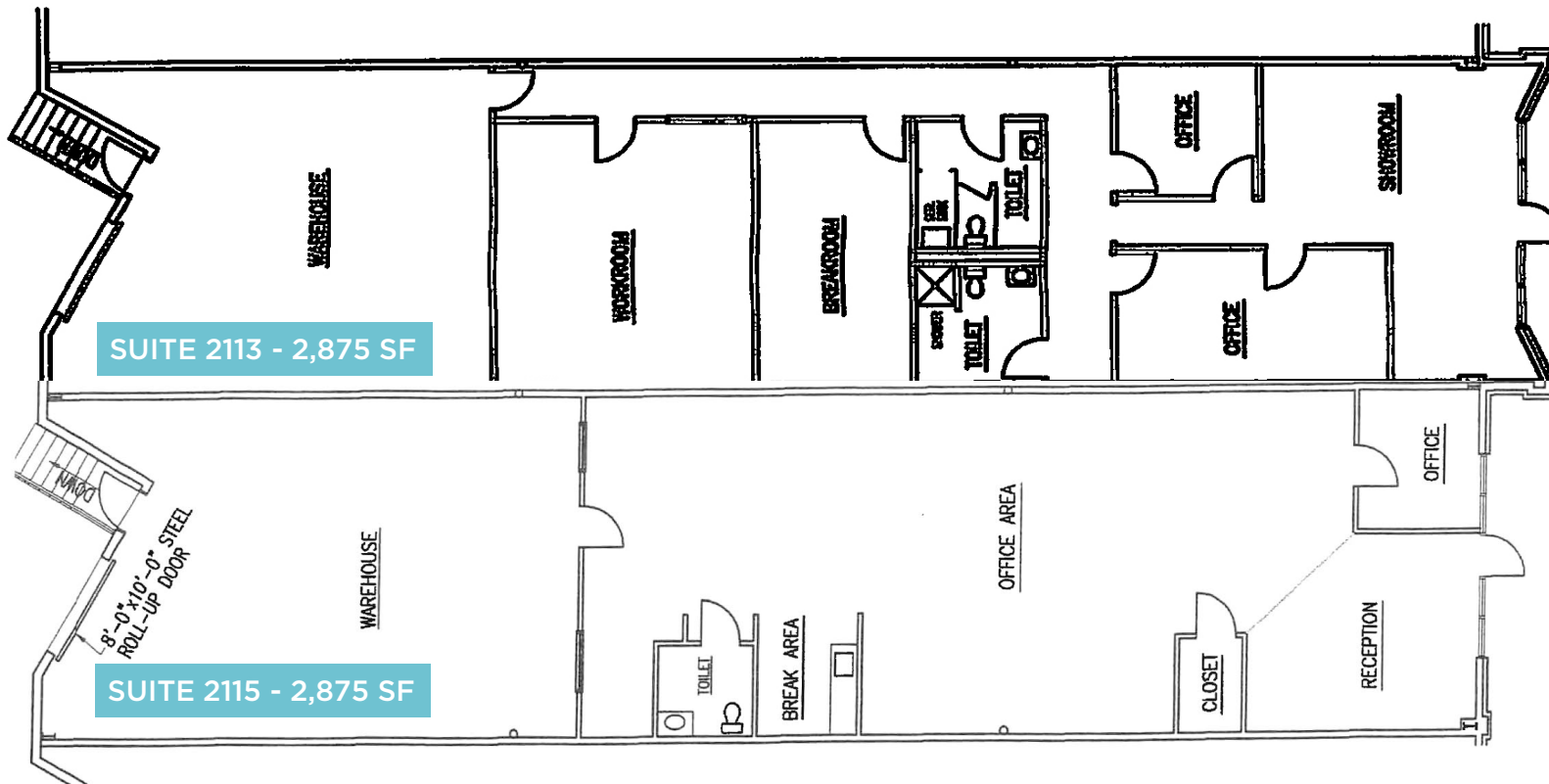



THALHIMER

Thalhimer Center
11100 W. Broad Street
Glen Allen, VA 23060
thalhimer.com



Craig Douglas
Senior Associate
804 344 7153
craig.douglas@thalhimer.com

Chrissy Chappell
Associate
804 344 7197
chrissy.chappell@thalhimer.com

Independently Owned and Operated / A Member of the Cushman & Wakefield Alliance

Cushman & Wakefield | Thalhimer © 2025. No warranty or representation, express or implied, is made to the accuracy or completeness of the information contained herein, and same is submitted subject to errors, omissions, change of price, rental or other conditions, withdrawal without notice, and to any special listing conditions imposed by the property owner(s). As applicable, we make no representation as to the condition of the property (or properties) in question.