

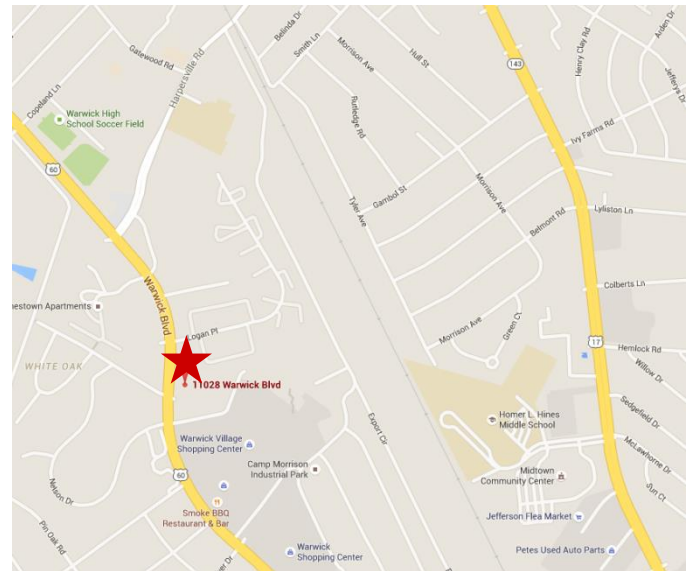

Property Features

- Executive office suites available
- Mid-city Newport News
- Double office suite \$695/month
- Conference room available
- Kitchen area shared
- One-year minimum lease term
- Suite L & M: 351 SF - Available Now



For more information, contact:

KENNETH PENROSE, JR.
Vice President
757 596 3704
ken.penrose@thalhimer.com

One BayPort Way, Suite 100
Newport News, VA 23606
www.thalhimer.com

Independently Owned and Operated / A Member of the Cushman & Wakefield Alliance

Cushman & Wakefield | Thalhimers © 2015. No warranty or representation, express or implied, is made to the accuracy or completeness of the information contained herein, and same is submitted subject to errors, omissions, change of price, rental or other conditions, withdrawal without notice, and to any special listing conditions imposed by the property owner(s). As applicable, we make no representation as to the condition of the property (or properties) in question.

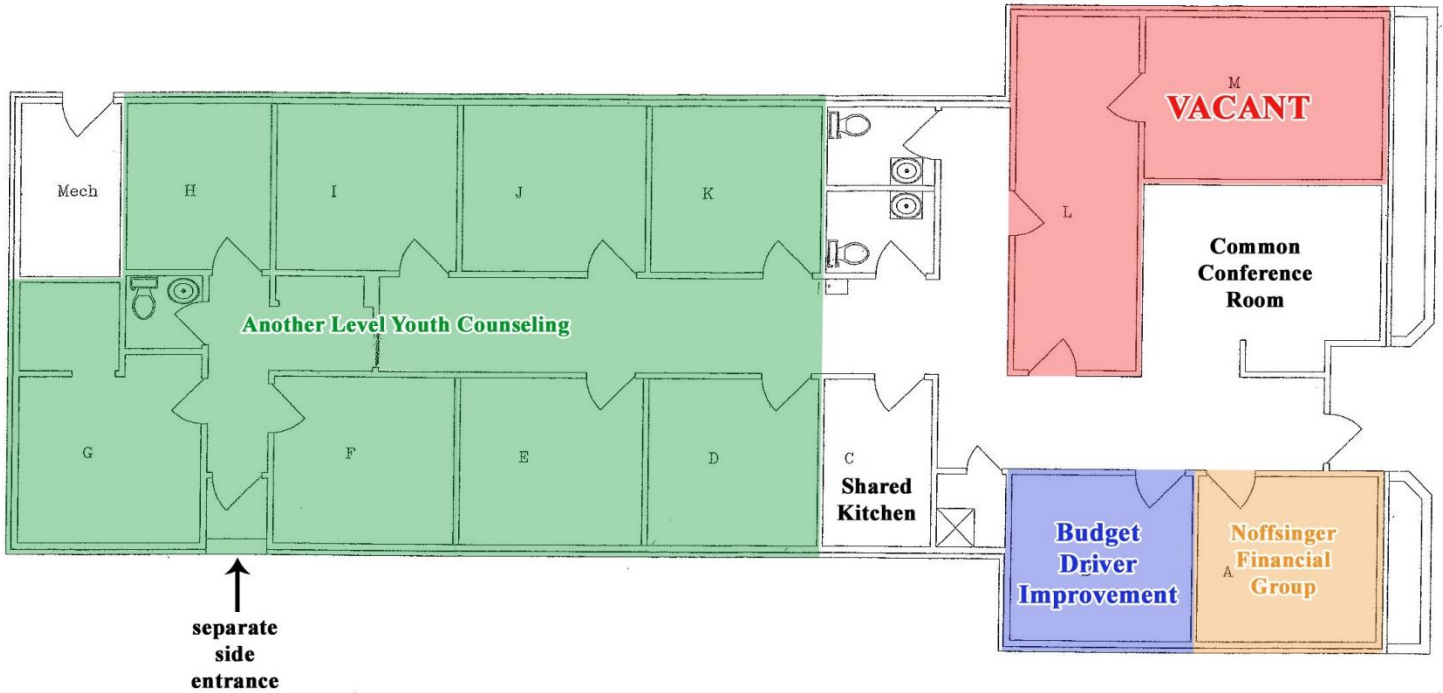

Floor Plan
Scale: 1/4"=1'-0"

For more information, contact:

KENNETH PENROSE, JR.
Vice President
757 596 3704
ken.penrose@thalhimer.com

One BayPort Way, Suite 100
Newport News, VA 23606
www.thalhimer.com