

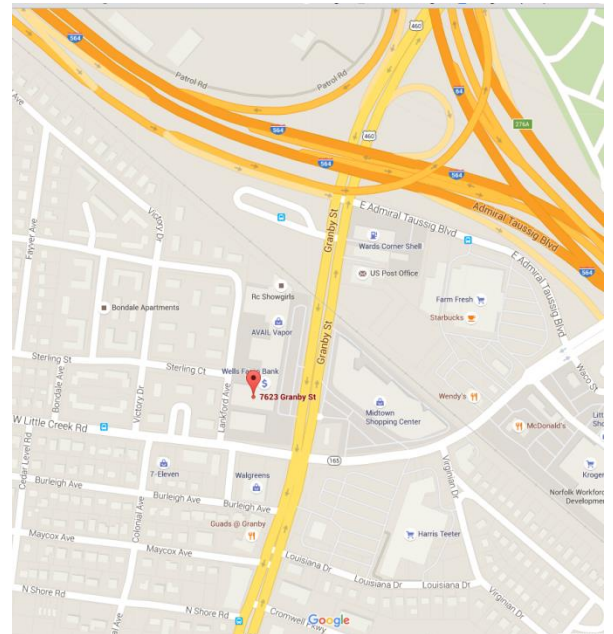

Property Features

- Available – 1,200 square feet
- Excellent exposure
- \$16.00 PSF/NNN
- 30,000 VPD through the intersection of Granby Street and Little Creek Road

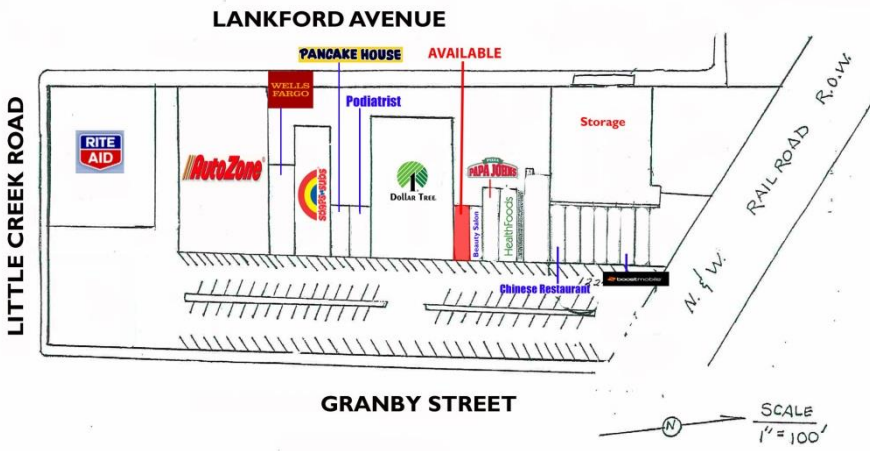

For more information, contact:

TED LEVIN
 Vice President
 757 499 4279
ted.levin@thalhimer.com

The Town Center of Virginia Beach
 222 Central Park Ave., Suite 1820
 Virginia Beach, VA 23462
www.thalhimer.com

RETAIL FOR LEASE
Wards Corner Shoppes

7623-7655 Granby Street, Norfolk, VA

Demographics			
	1 Mile	3 Miles	5 Miles
Population	13,748	131,127	212,170
Avg. HH Income	\$47,575	\$55,150	\$53,646

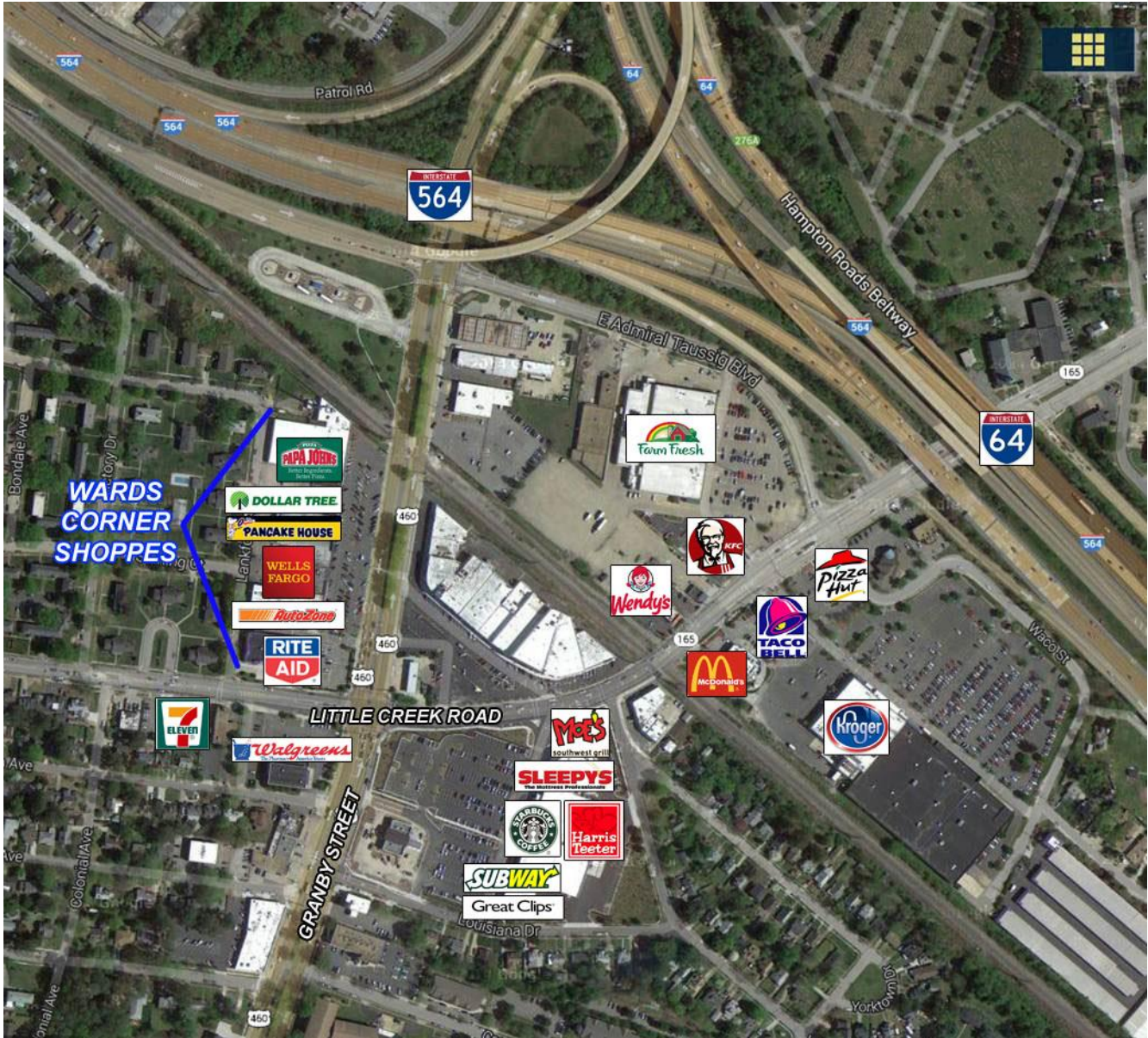

For more information, contact:

TED LEVIN
 Vice President
 757 499 4279
ted.levin@thalhimer.com

The Town Center of Virginia Beach
 222 Central Park Ave., Suite 1820
 Virginia Beach, VA 23462
www.thalhimer.com

Independently Owned and Operated / A Member of the Cushman & Wakefield Alliance

Cushman & Wakefield | Thalhimer © 2015. No warranty or representation, express or implied, is made to the accuracy or completeness of the information contained herein, and same is submitted subject to errors, omissions, change of price, rental or other conditions, withdrawal without notice, and to any special listing conditions imposed by the property owner(s). As applicable, we make no representation as to the condition of the property (or properties) in question.