

RETAIL FOR LEASE

Turning Basin

111 Virginia Street | Richmond, VA



CUSHMAN &
WAKEFIELD

THALHIMER

REILLY MARCHANT

First Vice President

804 697 3478

reilly.marchant@thalhimer.com

LOCATED IN THE HEART OF
DOWNTOWN RICHMOND

PROPERTY FEATURES

- 7,800 SF RESTAURANT SPACE
- Space can be demised
- Rare opportunity in Richmond's CBD
- All furniture, fixtures and equipment to convey
- Prominent well-known location in the Heart of Downtown Richmond
- Excellent foot traffic & daytime population
- Walking distance from hotels & other tourist attractions
- Parking available onsite
- A short walk from 65,000 employees of Richmond's most prestigious businesses



NEIGHBORHOOD DEMOGRAPHICS

	1 Mile	3 Miles	5 Miles
Population	20,813	132,343	269,671
No. of Households	13,266	62,035	117,338
Avg. HH Income	\$74,938	\$81,653	\$84,786
Daytime Population	74,780	191,398	315,675

PROPERTY FEATURES



JOIN NEARBY BUSINESSES



The Berkeley Hotel



CHOPT

OMNI HOTELS



PROPERTY PHOTOS



PROPOSED DEMISING PLAN

Tenant Suite Block Plan Options

Block Plan Option 5

Program	SF
Restaurant	6457
Office Tenant	1258
SMBW Existing	4747

▲ EXISTING EXIT/ENTRY

▲ NEW ENTRY/EXIT

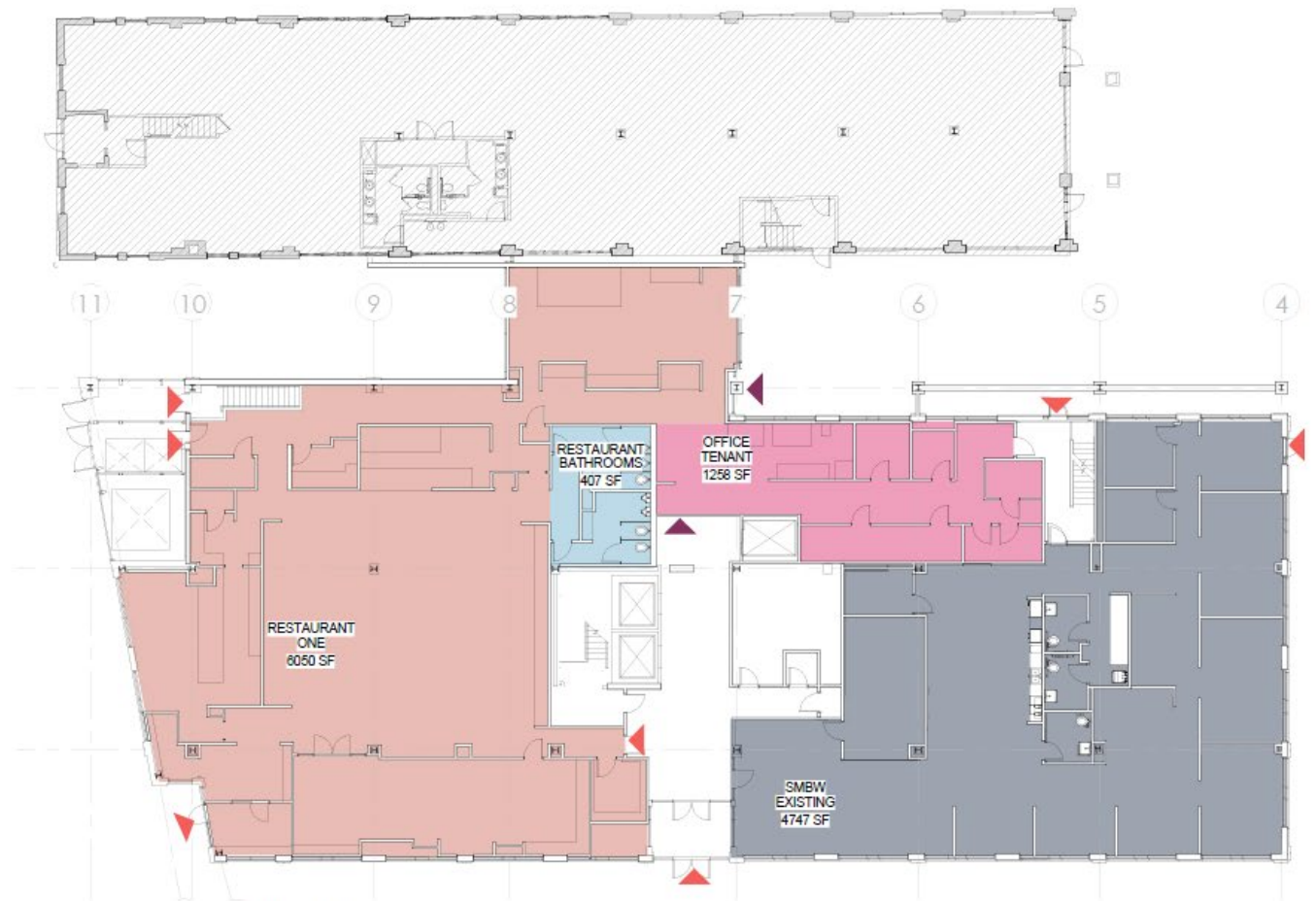

Floor Plan
Not to scale

AERIAL

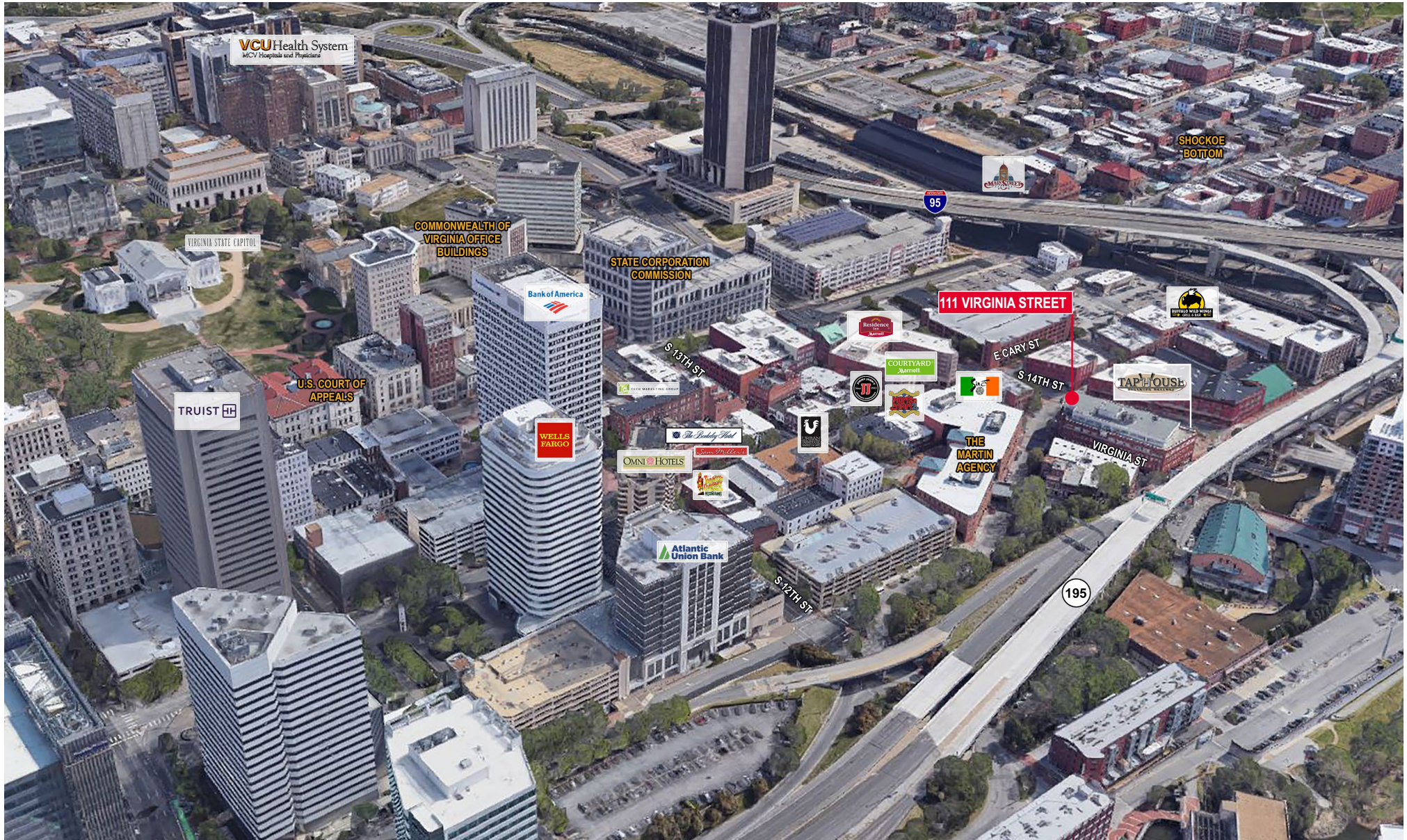



REILLY MARCHANT
 First Vice President
 804 697 3478
 reilly.marchant@thalhimer.com

Independently Owned and Operated / A Member of the Cushman & Wakefield Alliance

Cushman Wakefield | Thalhimer © 2023. No warranty or representation, express or implied, is made to the accuracy or completeness of the information contained herein, and same is submitted subject to errors, omissions, change of price, rental or other conditions, withdrawal without notice, and to any special listing conditions, imposed by the property owner(s). As applicable, we make no representation as to the condition of the property (or properties) in question.