

HILLTOP SQUARE SHOPPING CENTER

550 FIRST COLONIAL ROAD

Virginia Beach, VA 23451



PREMIER OUTPARCEL AVAILABLE – 3,500 SF to 8,280 SF

DEAN MARTIN
First Vice President
757 213 4158
dean.martin@thalhimer.com

CONNIE JORDAN NIELSEN
Senior Vice President
804 697 3569
connie.nielsen@thalhimer.com



Independently Owned and Operated / A Member of the Cushman & Wakefield Alliance

Cushman Wakefield | Thalhimer ©2023. No warranty or representation, express or implied, is made to the accuracy or completeness of the information contained herein, and same is submitted subject to errors, omissions, change of price, rental or other conditions, withdrawal without notice, and to any special listing conditions, imposed by the property owner(s). As applicable, we make no representation as to the condition of the property (or properties) in question.

HILLTOP SQUARE SHOPPING CENTER

550 FIRST COLONIAL ROAD

Virginia Beach, VA 23451

PROPERTY FEATURES

- 3,500 SF to 8,280 SF available (can be subdivided)
- Anchored by Walmart Supercenter
- Located at I-264, Laskin Road, and First Colonial Road
- Approximately 59,000 VPD at nearest intersection
- Immediate access to I-264 (66,000 VPD)
- Minutes to Virginia Beach Oceanfront, multiple private golf courses, high income neighborhoods and Oceana military base

Join Tenants / Nearby Retailers

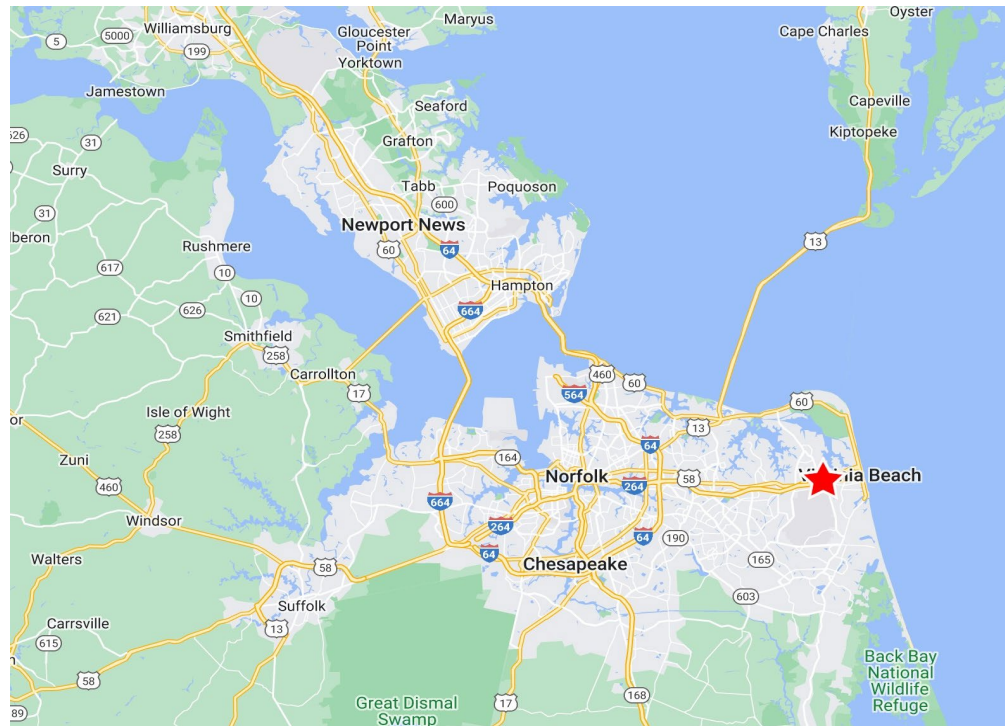

Demographics			
	1 Mile	3 Miles	5 Miles
Population	9,457	61,800	130,911
Daytime Population	10,357	73,479	150,503
No. of Households	4,455	27,578	54,081
Average Household Income	\$89,737	\$118,909	\$121,129
Median Household Income	\$63,795	\$77,777	\$81,560
Median Age	33.1	37.9	38.1
Education 25+	69.2%	77.5%	74.6%

AS-BUILT WITH DIMENSIONS

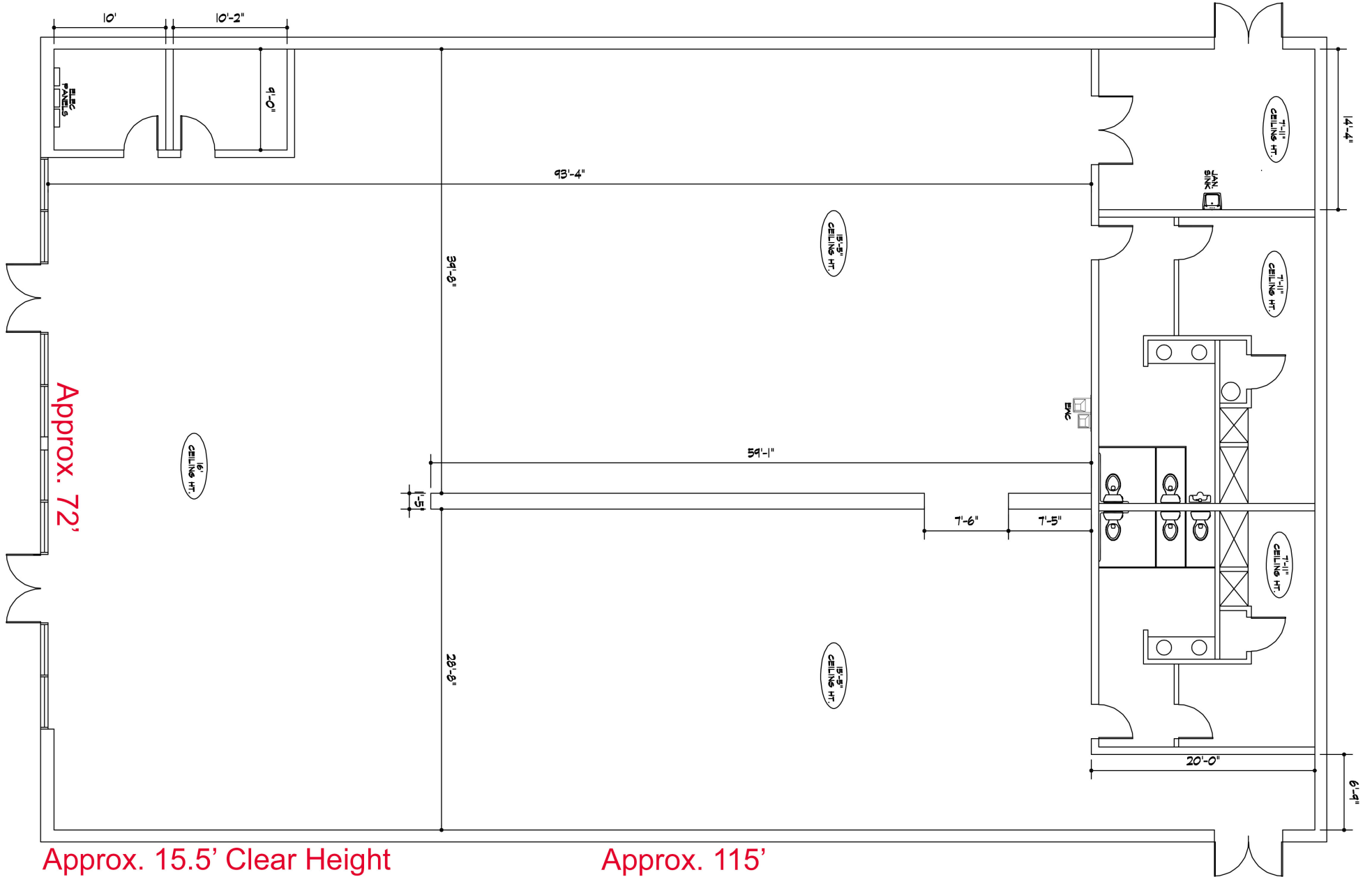

Approx. 15.5' Clear Height

Approx. 115'

Approx. 72'

AS-BUILT WITH DIMENSIONS

Pad Building – 8,280 SF
Existing conditions LOD | Proposed Demising Plan

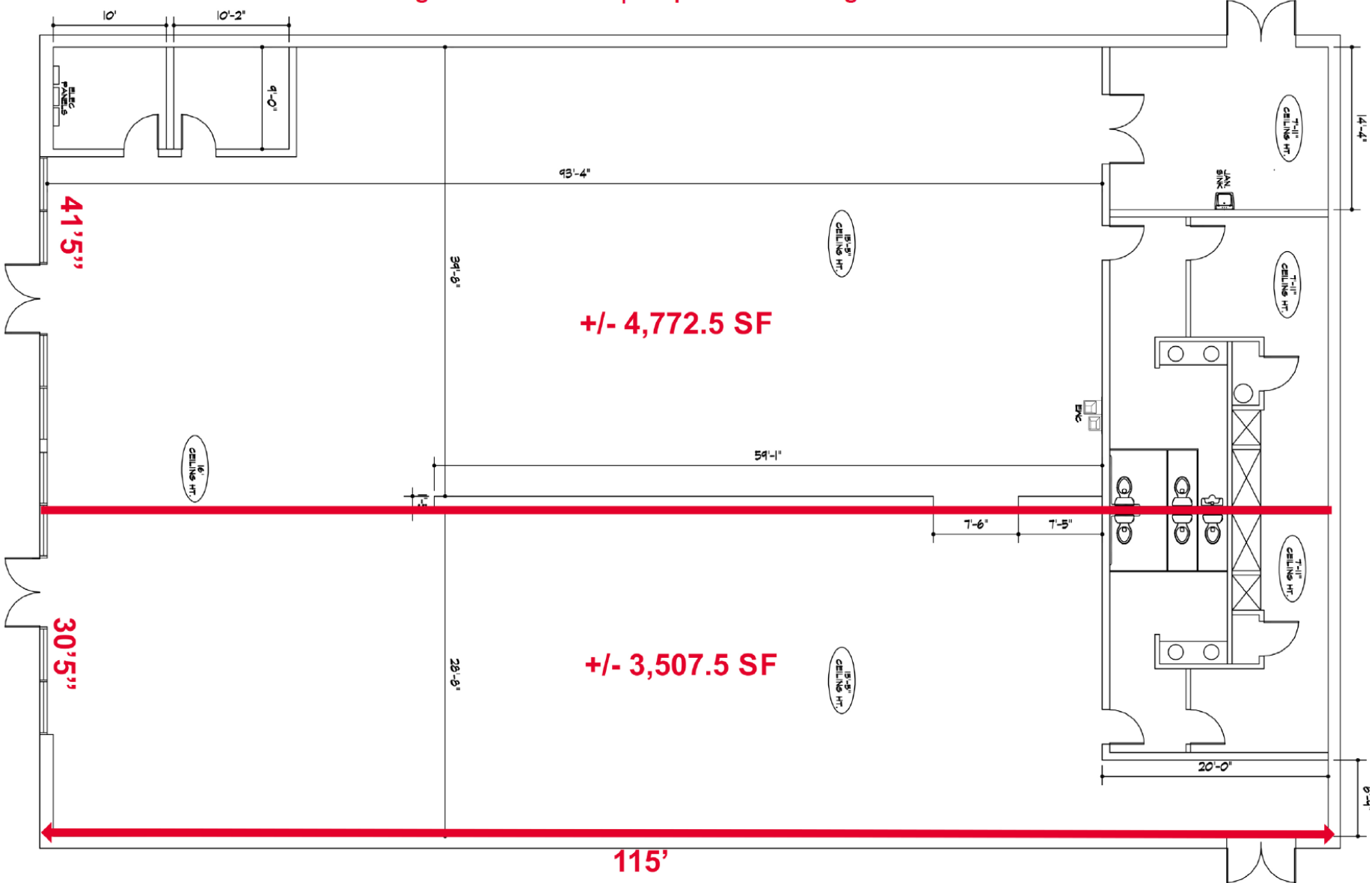

FRANCIS & REEVE
SPACE PLANNING | INTERIORS
6.29.2022
S. REEVE

AS-BUILT DRAWING

550 FIRST COLONIAL ROAD
HILLTOP NORTH SHOPPING CENTER
VIRGINIA BEACH, VIRGINIA

8,280 SF

AERIAL

