

FOR LEASE

McK Business Park

3010 Mine Road / Fredericksburg, VA. 22408



**CUSHMAN &
WAKEFIELD**

THALHIMER

VIRGIL NELSON, CCIM

Senior Vice President

540 322 4150

virgil.nelson@thalhimer.com

WILSON GREENLAW, CCIM, SIOR

First Vice President

540 322 4156

wilson.greenlaw@thalhimer.com

Industrial Available

15,000 – 135,000 SF

PROPERTY HIGHLIGHTS



PROPERTY FEATURES

- Total SF available: 135,000 SF
- Multiple configurations available from 14,400 to 135,000 SF
- Units available with docks and drive-in doors
- Outdoor storage available
- Zoned I2 heavy industrial
- Access to I-95 and Route 301

CURRENT AVAILABILITIES

Unit	SF	Lease Rate	Timing
B	32,000	\$6.95 PSF NNN (\$0.80)	Now
C	14,400	\$6.95 PSF NNN (\$0.80)	Now
F	24,000	\$6.95 PSF NNN (\$0.80)	Aug. 2025
G	45,000	\$6.95 PSF NNN (\$0.80)	Oct. 2024
H	44,650	\$6.95 PSF NNN (\$0.80)	Jun. 2024

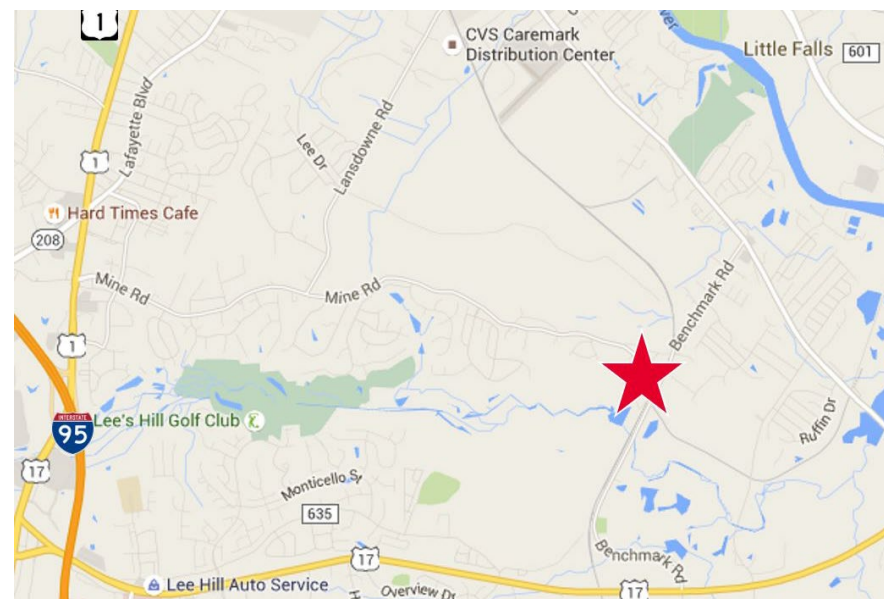

PROPERTY SITE PLAN

Spaces range from manufacturing to distribution to shop. NNN = \$0.80 PSF. Additional acreage available on-site. Located at the intersection of Benchmark Road and Mine Road, it is convenient to the Route 2 corridor, Lee's Hill and Massaponax. McK Business Park also provides excellent access to I-95 and Route 301.



BUILDING NUMBER & ADDRESS	TOTAL SF	DOCKS	CLEAR HEIGHT	DRIVE-IN DOORS	POWER (AMPS)	PRODUCTION/ WAREHOUSE FACILITY SF	OFFICE SF	BUILT
BUILDING B 3000 Mine Road	32,000 SF	2	19'	3	1,800	32,000	0	1970
BUILDING C 3004 Mine Road	14,400 SF	0	24'	1	1,200	14,400 (Storage Only)	0	1969
BUILDING F 3006 Mine Road	24,000 SF	1	24'	3	1,600	24,000	196	1978/ 1990
BUILDING G 3018 Mine Road	45,000 SF	2	24'	1	4,000	45,000	0	1978
BUILDING H 3000 Mine Road	44,650 SF	11	28'	0	800	41,650	3,000	1987

*Additional options may be available; Inquire with broker

FLOOR PLANS

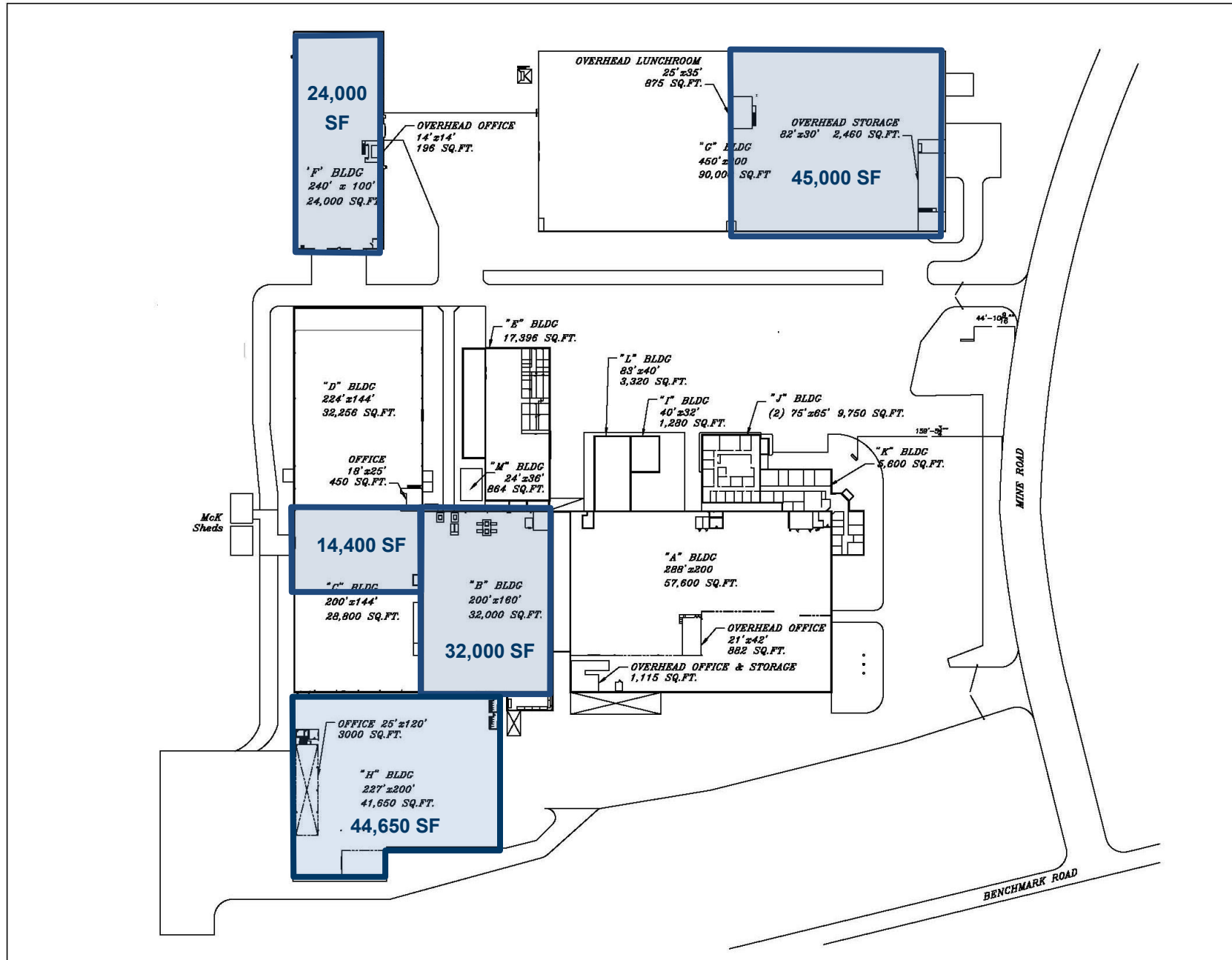

FLOOR PLANS

Building B

32,000 SF
19' Clear

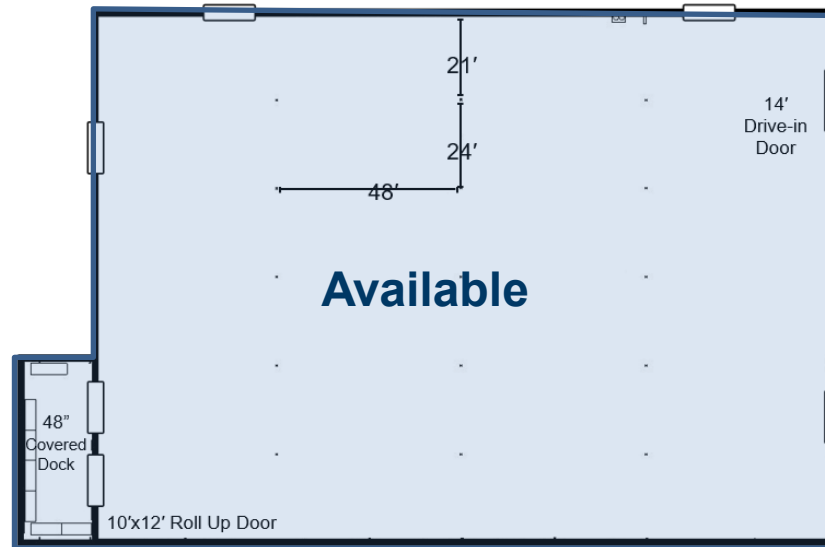

Building C

14,400 SF
24' Clear

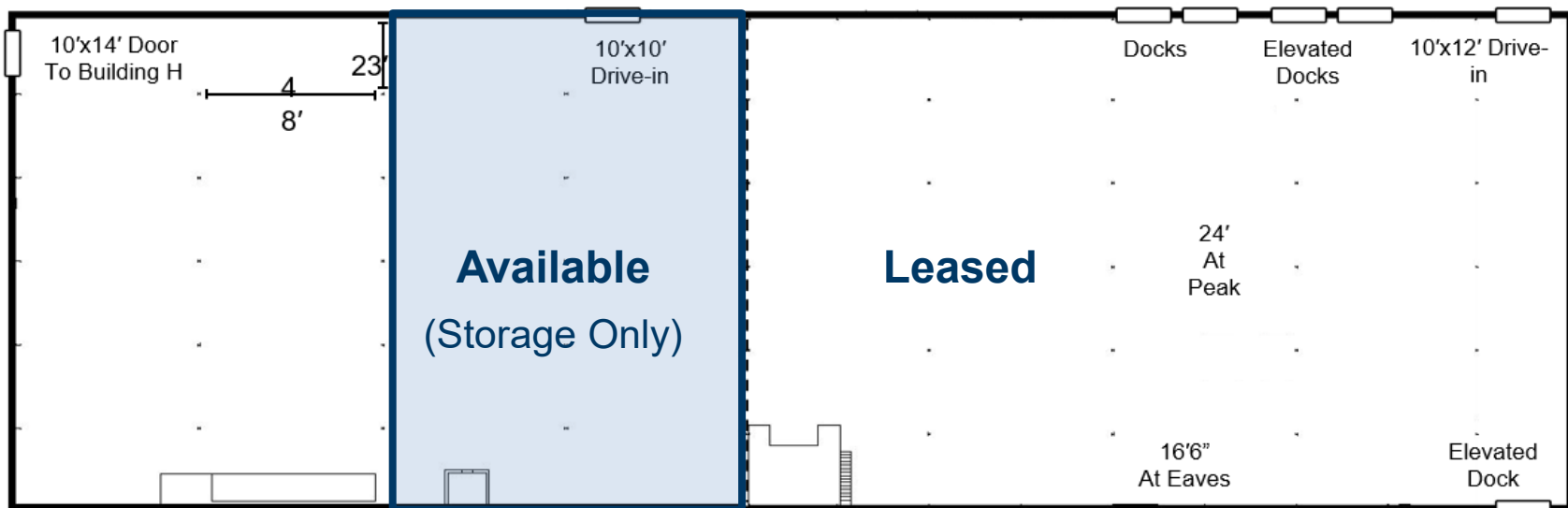

FLOOR PLANS

Building F

24,000 SF
24' Clear

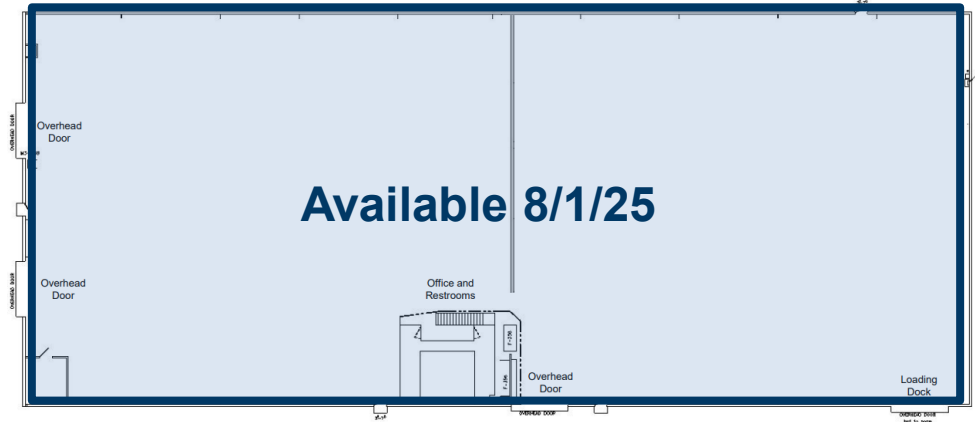

Building H

44,650 SF
28' Clear

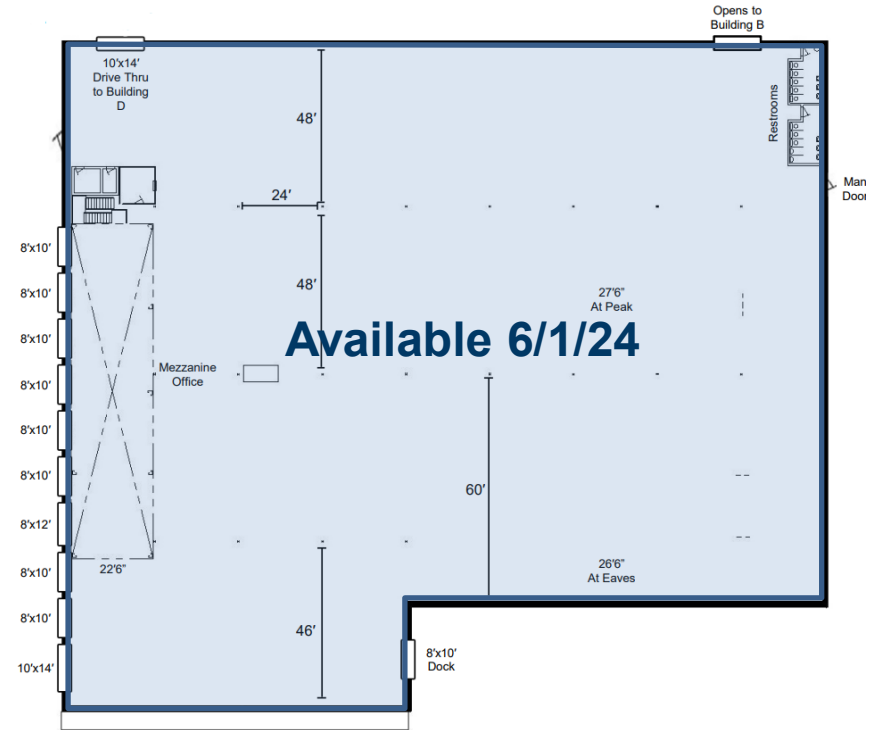

Building G

45,000 SF
24' Clear

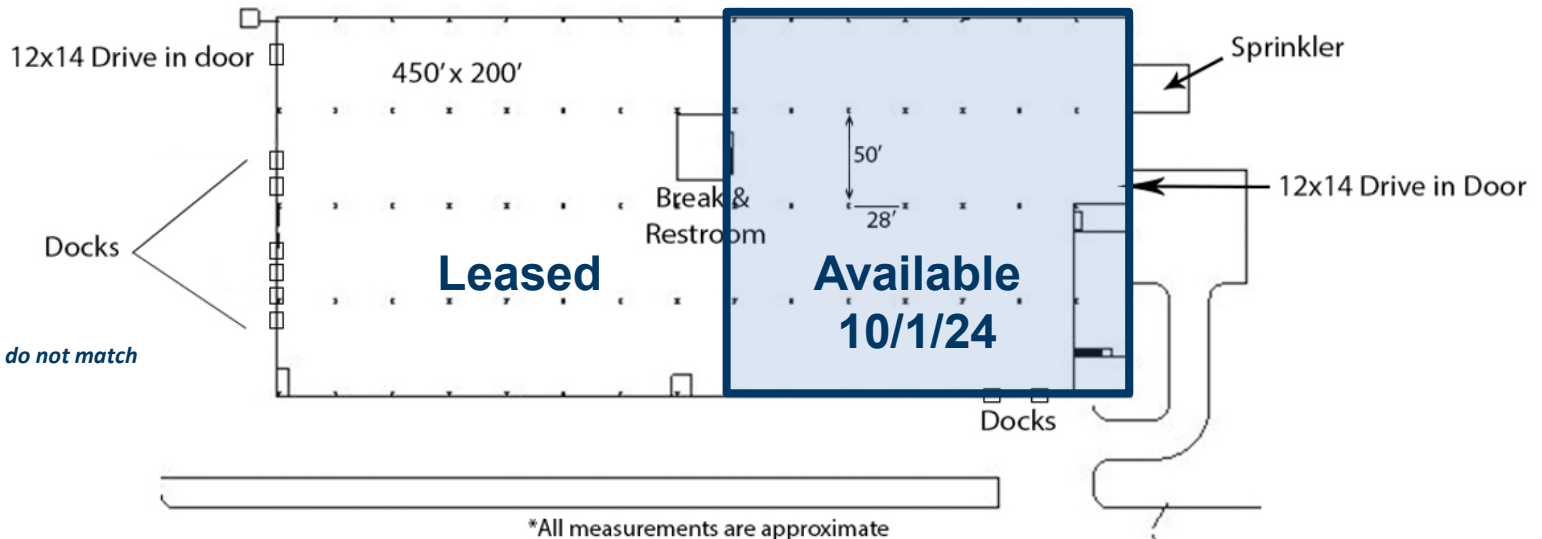

PROPERTY AERIAL MAP



VIRGIL NELSON, CCIM
Senior Vice President
540 322 4150
virgil.nelson@thalhimer.com

WILSON GREENLAW, CCIM, SIOR
First Vice President
540 322 4156
wilson.greenlaw@thalhimer.com

1125 Emancipation Hwy. Suite 350
Fredericksburg, VA 22401
www.thalhimer.com

Independently Owned and Operated / A Member of the Cushman & Wakefield Alliance

Cushman Wakefield | Thalhimer ©2024. No warranty or representation, express or implied, is made to the accuracy or completeness of the information contained herein, and same is submitted subject to errors, omissions, change of price, rental or other conditions, withdrawal without notice, and to any special listing conditions, imposed by the property owner(s). As applicable, we make no representation as to the condition of the property (or properties) in question.