

# Ferry Farm Shopping Center

201-207 Kings Highway | Stafford County, Virginia 22405

Retail | For Lease | Anchor Opportunity | Shop Space Available



[VIRTUAL TOUR](#)

[ADA SHEET](#)



Contact | Jim Ashby | Senior Vice President | 804 697 3455 | [jim.ashby@thalhimer.com](mailto:jim.ashby@thalhimer.com)

| Virgil Nelson, CCIM | Senior Vice President | 540 322 4150 | [virgil.nelson@thalhimer.com](mailto:virgil.nelson@thalhimer.com)

Eagle Village  
1125 Emancipation Highway; Ste. 350, Fredericksburg, VA 22401  
[www.thalhimer.com](http://www.thalhimer.com)



## FEATURES

- **ANCHOR OPPORTUNITY 36,254 SF (CAN BE DIVIDED)**
- 61,774 SF neighborhood shopping center
- Intersection of Kings Highway (State Route 3) and Ferry Road (Route 606)
- ±200 parking spaces
- 50,000+ population within 3 miles
- Average household income - \$120,000+
- Just minutes from downtown Fredericksburg



**48,000 VPD**  
VPD – Kings Highway



**LOD**

99,196  
**POPULATION**

\$126,321  
**AVERAGE INCOME**

111,050  
**DAYTIME POPULATION**

DEMOGRAPHICS				
	1 MILE	3 MILES	5 MILES	10 MILES
<b>Population</b>	6,171	48,828	99,196	224,569
<b>Avg. Household Income</b>	\$125,308	\$126,063	\$126,321	\$132,811
<b>Daytime Population</b>	9,418	56,348	111,050	212,868

# JOIN TENANTS & NEARBY RETAILERS



## CENTER SITE PLAN

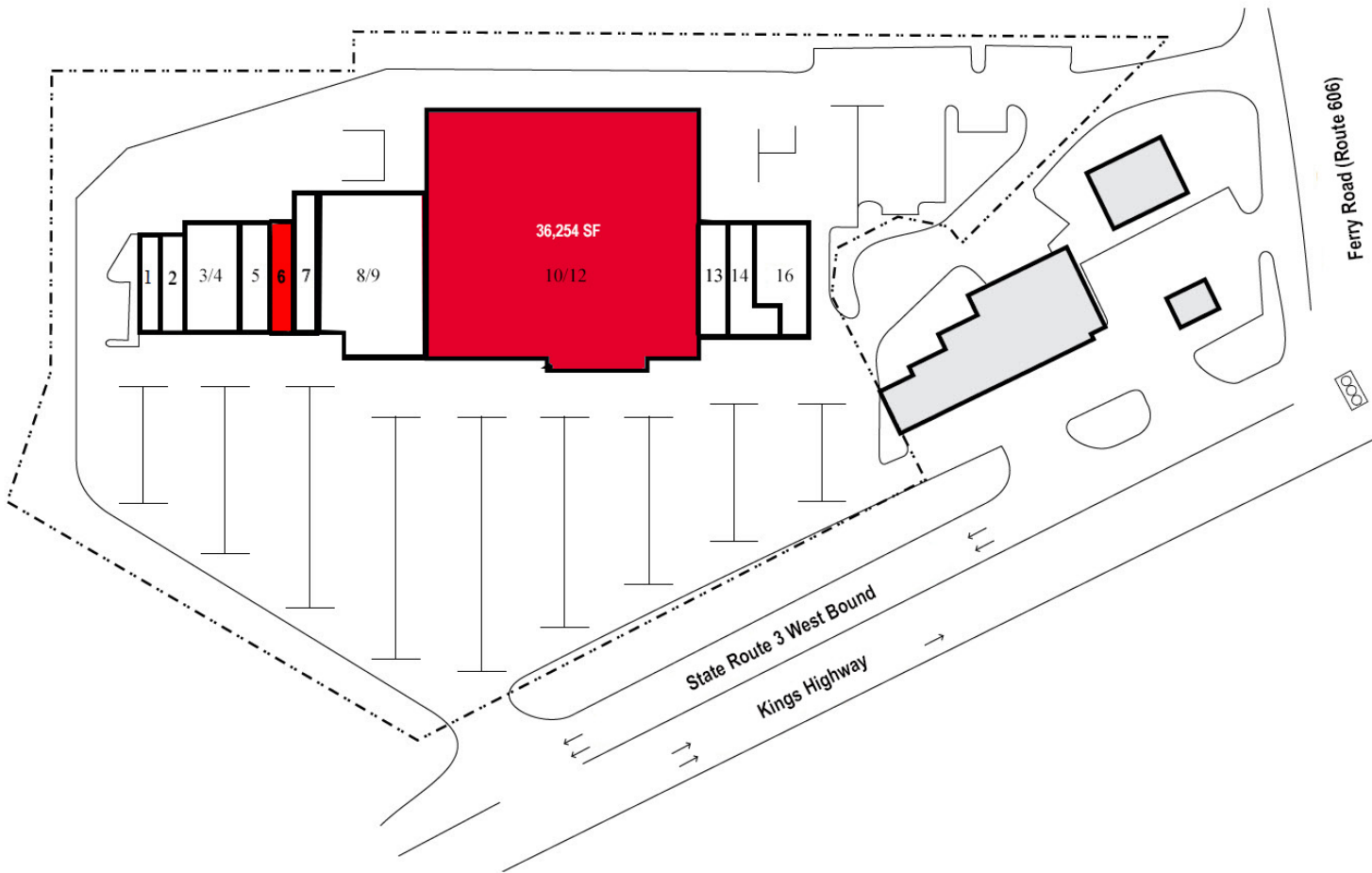

SPACE	TENANT	SF
1	H&R Block	1,260
2	Jacob's Ladder	1,260
3/4	Vinny's Italian Restaurant	3,200
5	Moon Star Chinese	2,000
<b>6</b>	<b>AVAILABLE</b>	<b>1,200</b>
7	International Mart	1,800
8/9	New Restoration Church	8,800
<b>10/12</b>	<b>AVAILABLE</b>	<b>36,254</b>
13	Ferry Farm Health & Wellness	2,250
14	Berkshire Hathaway	1,750
16	Dairy Queen	2,000

# PROPERTY PHOTOS

FERRY FARM  
SHOPPING  
CENTER



# AERIAL OVERVIEW

## FERRY FARM SHOPPING CENTER

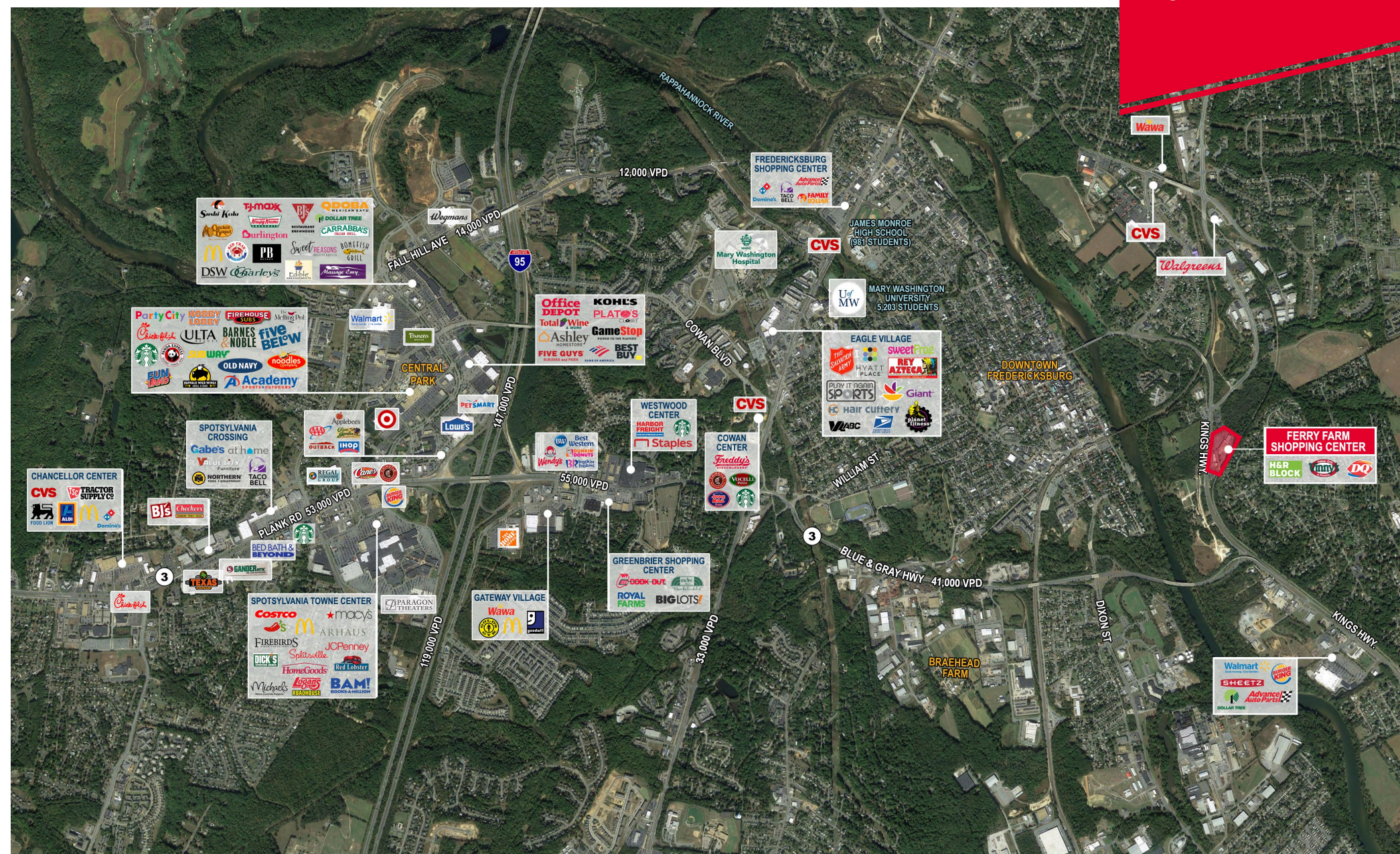

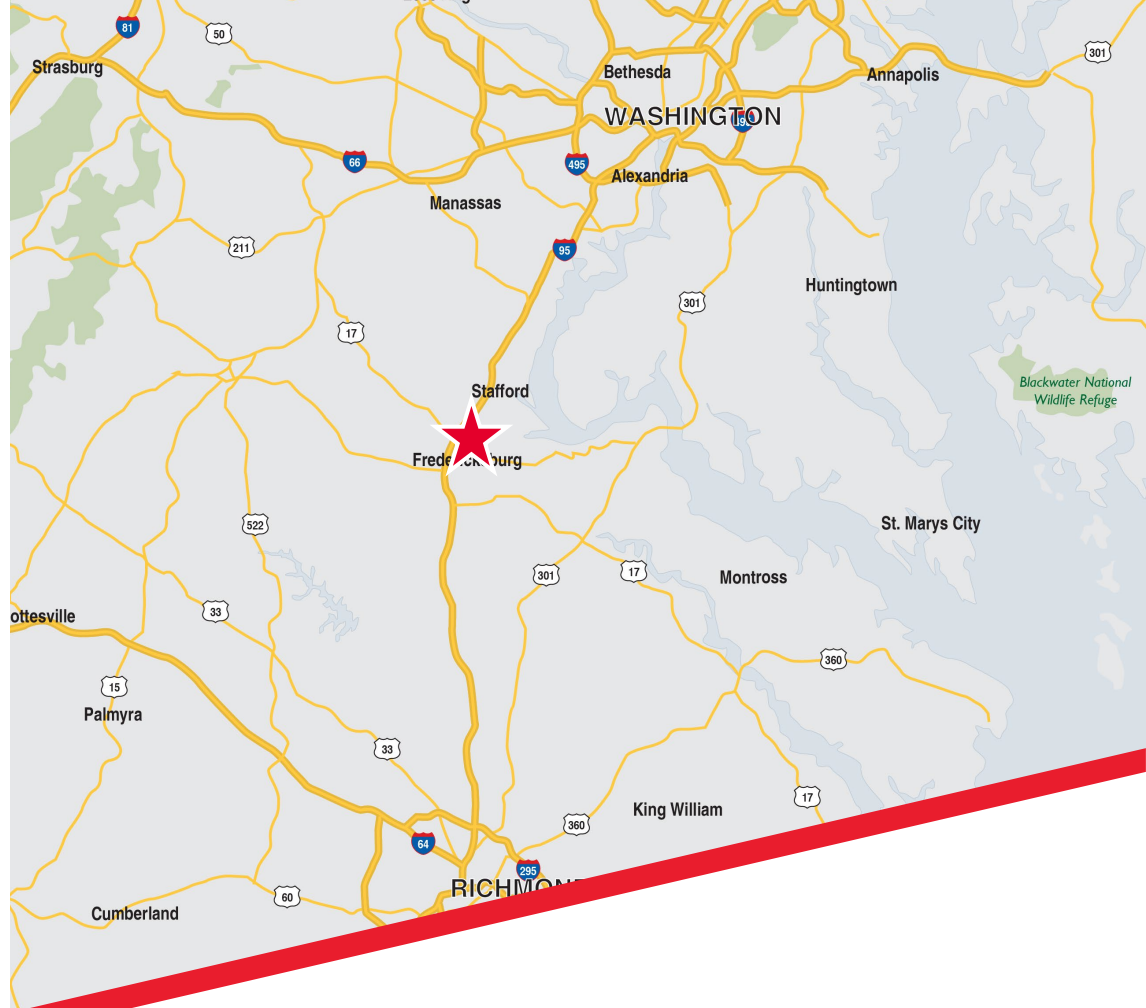
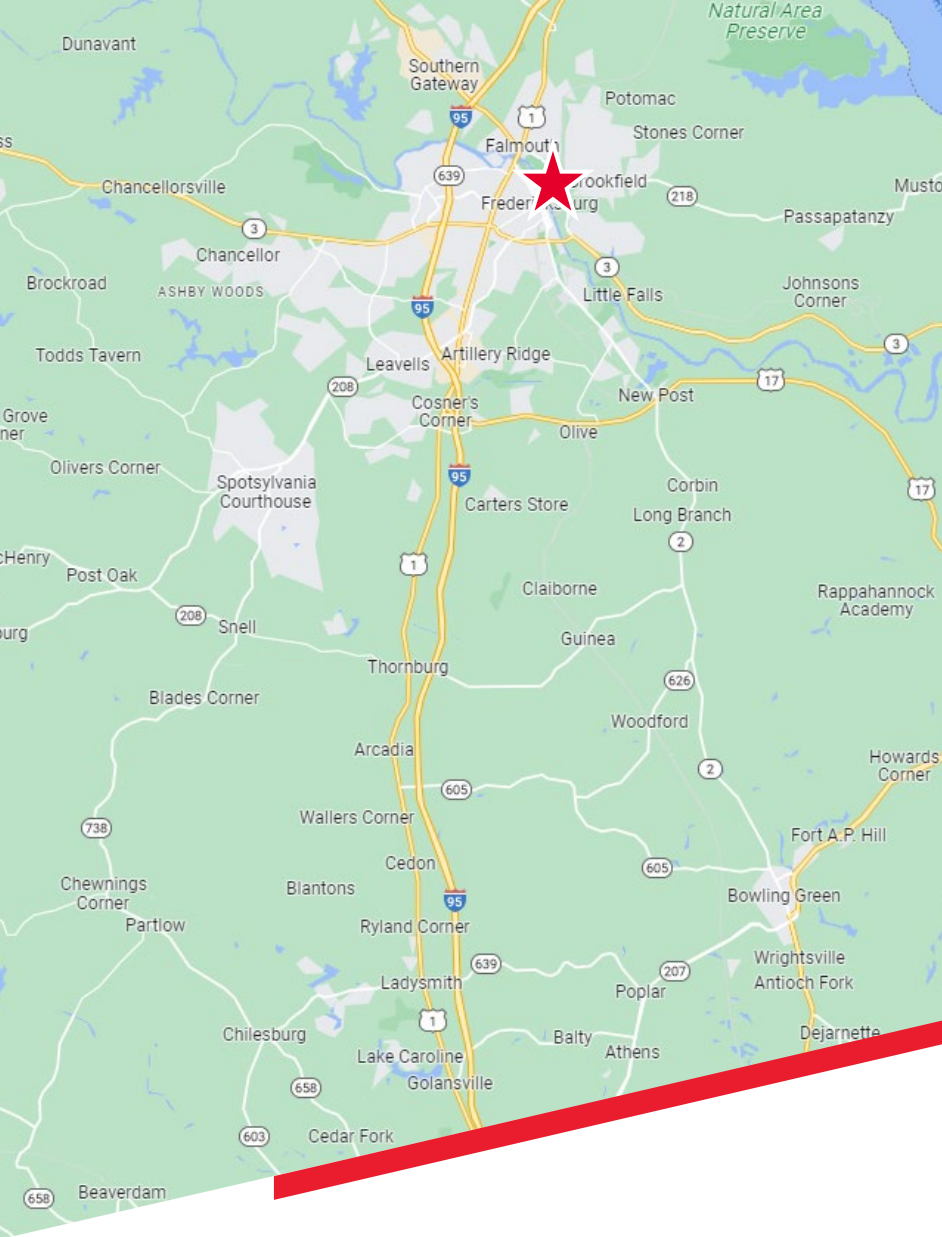

Jim Ashby  
Senior Vice President  
804 697 3455  
jim.ashby@thalhimer.com

Virgil Nelson, CCIM  
Senior Vice President  
540 322 4150  
virgil.nelson@thalhimer.com



Eagle Village  
1125 Emancipation Highway; Ste. 350, Fredericksburg, VA 22401

[www.thalhimer.com](http://www.thalhimer.com)

*Independently Owned and Operated / A Member of the Cushman & Wakefield Alliance*

Cushman Wakefield | Thalhimer © 2024. No warranty or representation, express or implied, is made to the accuracy or completeness of the information contained herein, and same is submitted subject to errors, omissions, change of price, rental or other conditions, withdrawal without notice, and to any special listing conditions, imposed by the property owner(s). As applicable, we make no representation as to the condition of the property (or properties) in question.