

# HIGHLAND II AT GLEN FOREST

RICHMOND, VA

Better never settles

HIGHLAND II

7229

## CLIENT

Jack Sitt Real Estate & Gulf Islamic Investments

## LOCATION

Richmond, VA

## REAL ESTATE TYPE

Office/Medical

## SQUARE FOOTAGE

67,899 SF

## PROJECT OVERVIEW

Since taking over the leasing assignment in late 2021, Thalhimer's Amy Broderick and Kate Hosko have repositioned Highland II, a class A office building that is part of the Glen Forest Office Park. Utilizing their robust market knowledge, the team advised the new property ownership on essential property improvements that included an extensive lobby renovation, whiteboxing vacant suites to position them for new tenants, and targeting medical office users to build on the area's existing healthcare base.

Leasing activity has topped 19,000 SF in the last twenty-four months and brought four new medical practices to the Henrico County complex.

## SOLUTIONS

- Competitive Market Survey
- Repositioning & Renovation Guidance
- Extensive Lobby Updates
- Whiteboxing to Position Suites for Market
- Target Conversion to Medical Office Users





# HIGHLAND II

GLEN FOREST OFFICE PARK | RICHMOND, VA



THALHIMER

## CLIENT

Jack Sitt Real Estate & Gulf Islamic Investments

## LOCATION

Richmond, VA

## REAL ESTATE TYPE

Office/Medical

## SQUARE FOOTAGE

67,899 SF





# HIGHLAND II

GLEN FOREST OFFICE PARK | RICHMOND, VA

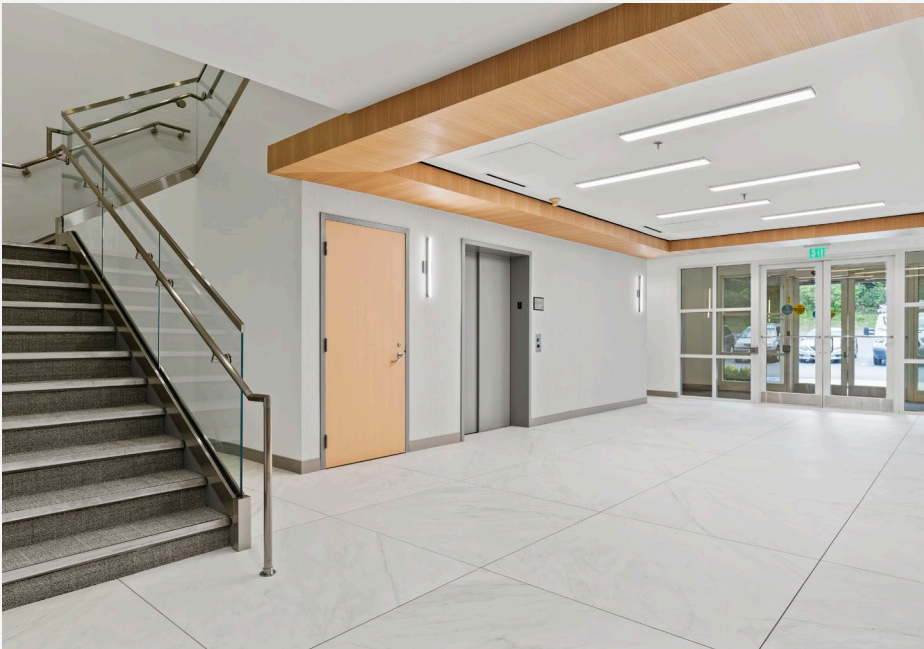

**CLIENT**

Jack Sitt Real Estate & Gulf Islamic Investments

**LOCATION**

Richmond, VA

**REAL ESTATE TYPE**

Office/Medical

**SQUARE FOOTAGE**

67,899 SF





# HIGHLAND II

GLEN FOREST OFFICE PARK | RICHMOND, VA



## CLIENT

Jack Sitt Real Estate & Gulf Islamic Investments

## LOCATION

Richmond, VA

## REAL ESTATE TYPE

Office/Medical

## SQUARE FOOTAGE

67,899 SF





# HIGHLAND II

GLEN FOREST OFFICE PARK | RICHMOND, VA



THALHIMER

## CLIENT

Jack Sitt Real Estate & Gulf Islamic Investments

## LOCATION

Richmond, VA

## REAL ESTATE TYPE

Office/Medical

## SQUARE FOOTAGE

67,899 SF





# HIGHLAND II AT GLEN FOREST

RICHMOND, VA

Better never settles



## CLIENT

Jack Sitt Real Estate & Gulf Islamic Investments

## LOCATION

Richmond, VA

## REAL ESTATE TYPE

Office/Medical

## SQUARE FOOTAGE

67,899 SF

## LISTING AGENTS



Amy Broderick  
Senior Vice President



Kate Hosko  
Vice President

