

OFFICE FOR LEASE

PACIFIC LIFE BUILDING

700 Main Street, Lynchburg, Virginia



UP TO 81,00 SF OF CONTIGUOUS SPACE AVAILABLE



THALHIMER



PROPERTY FEATURES

- The premier office building in the Lynchburg CBD
- Flexible floor plans from 8,750 to 24,000 SF
- Up to 81,000 SF of contiguous space available with potential for additional square footage
- Fiber optic communications available
- Back-up generator in place
- Ample on-site parking available
- Newly renovated cafeteria area
- Available immediately

FLOOR PLAN

First Floor

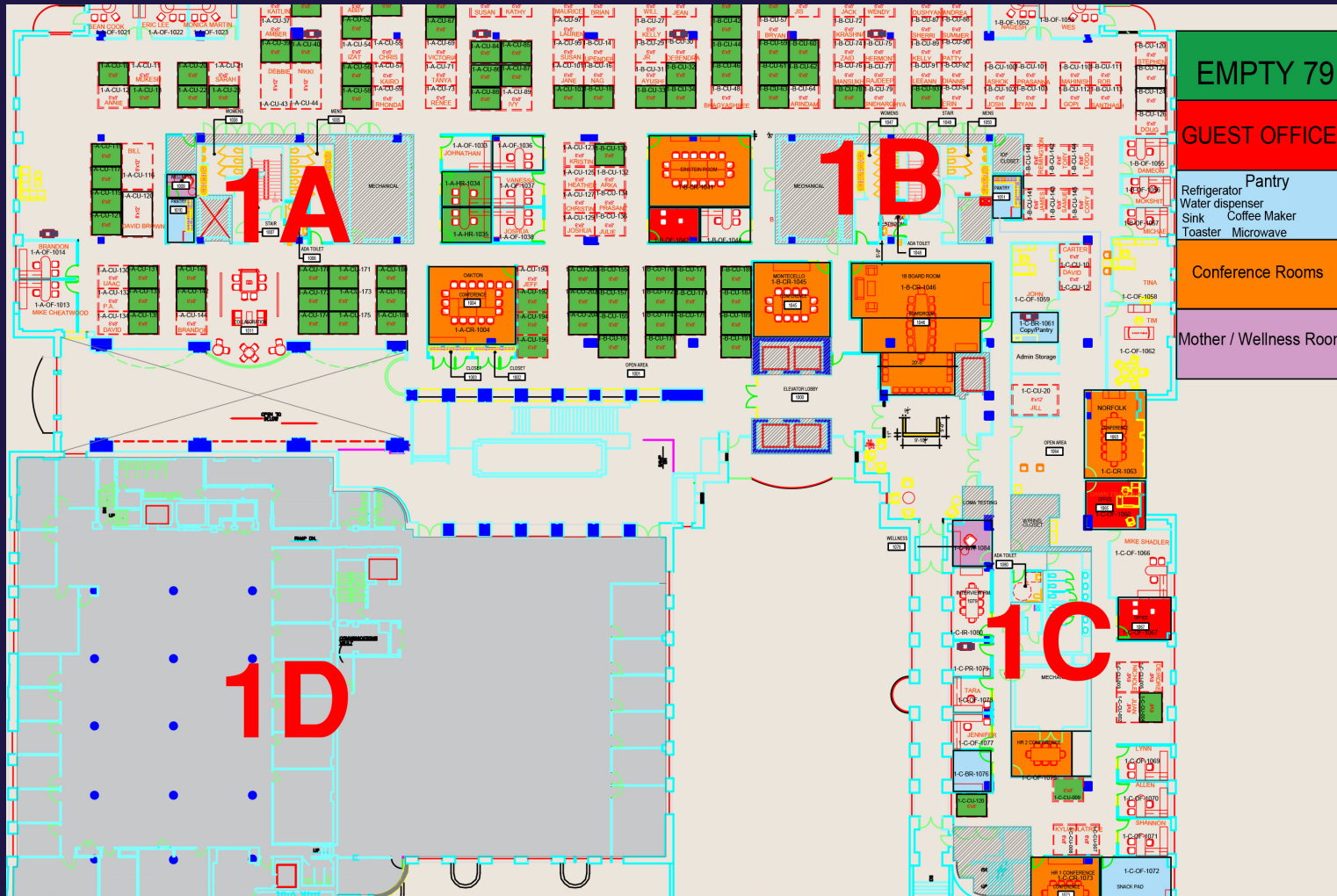

FLOOR PLAN

Second Floor

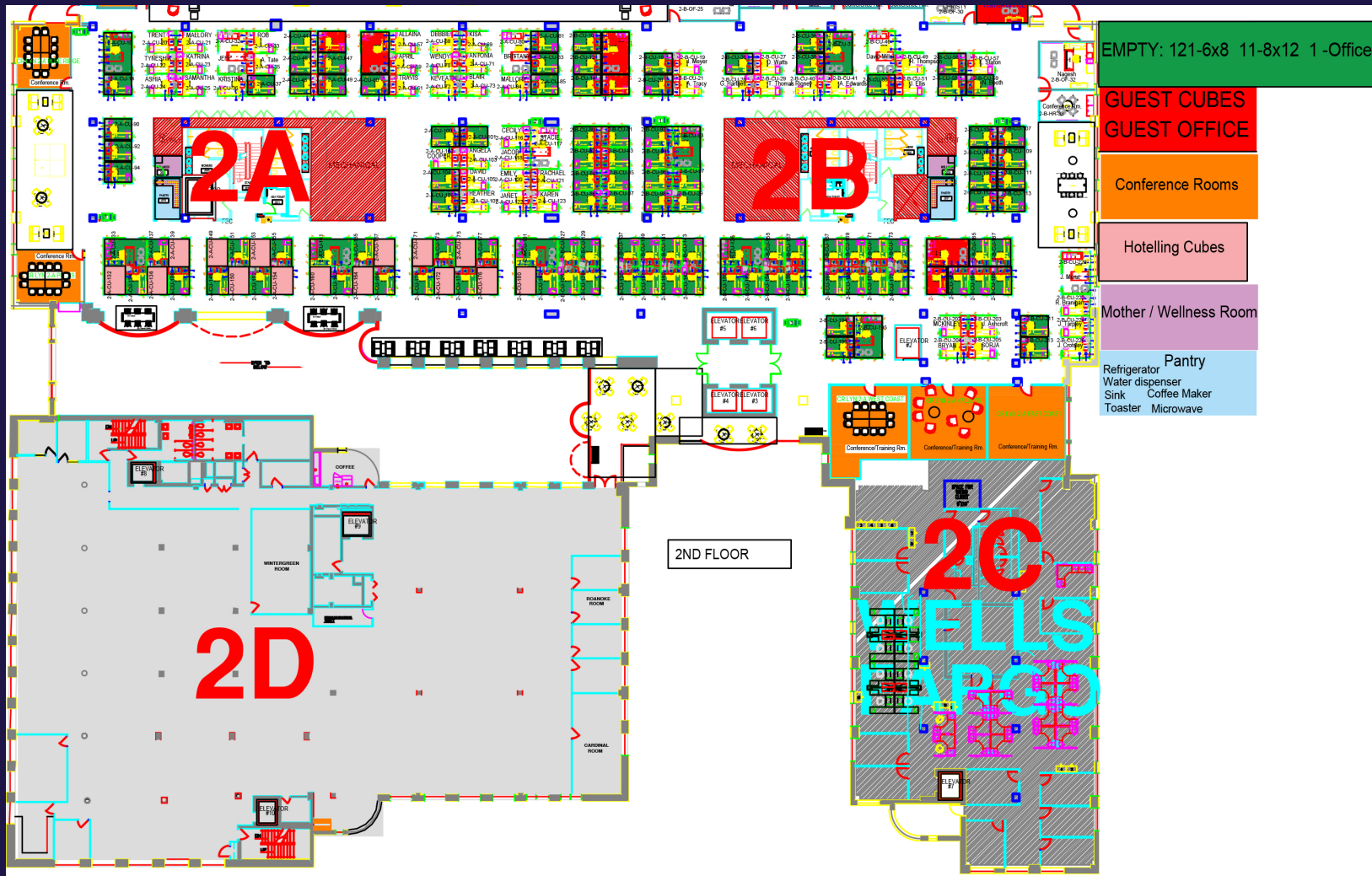

FLOOR PLAN

Third Floor

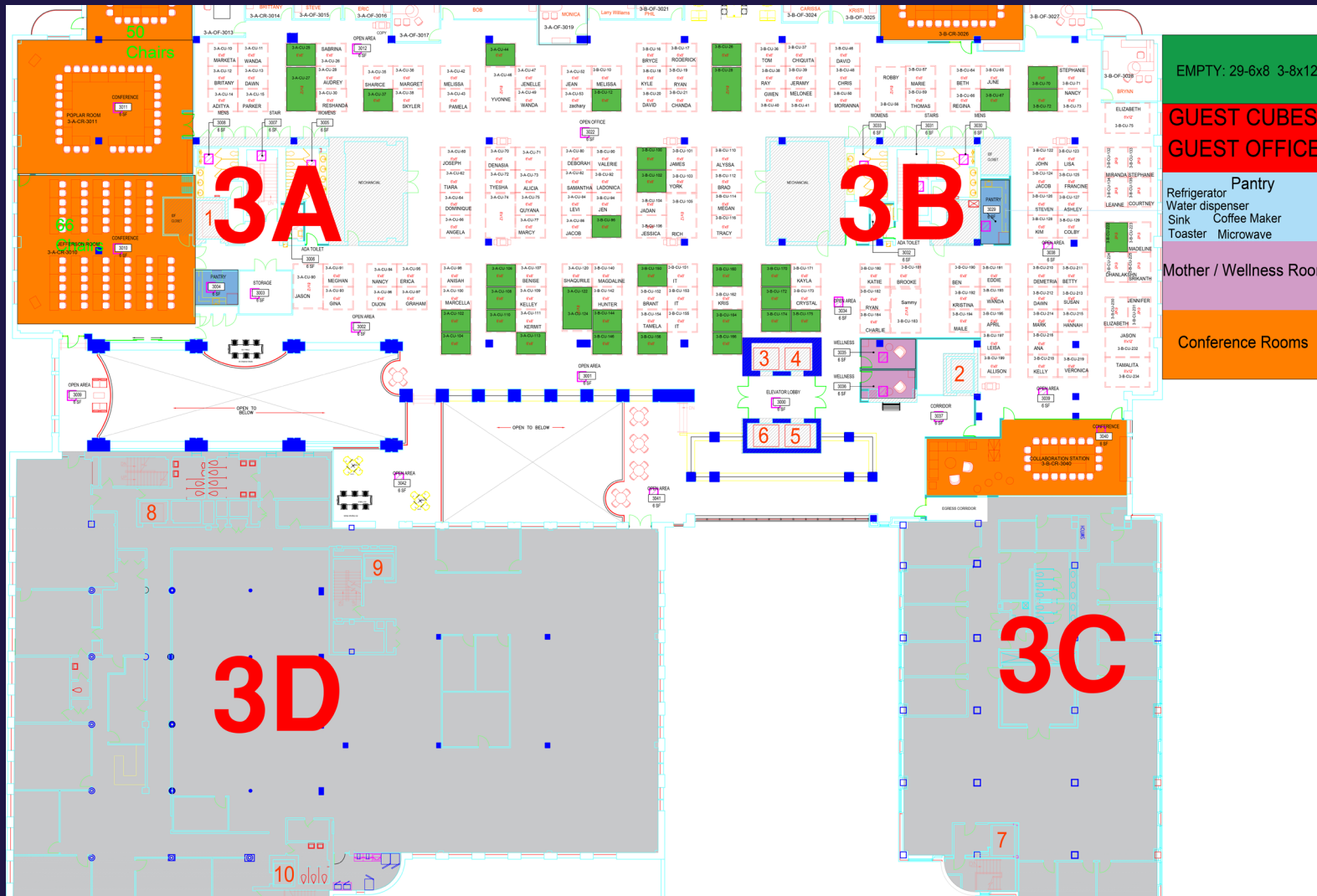

FLOOR PLAN

Terrace Floor

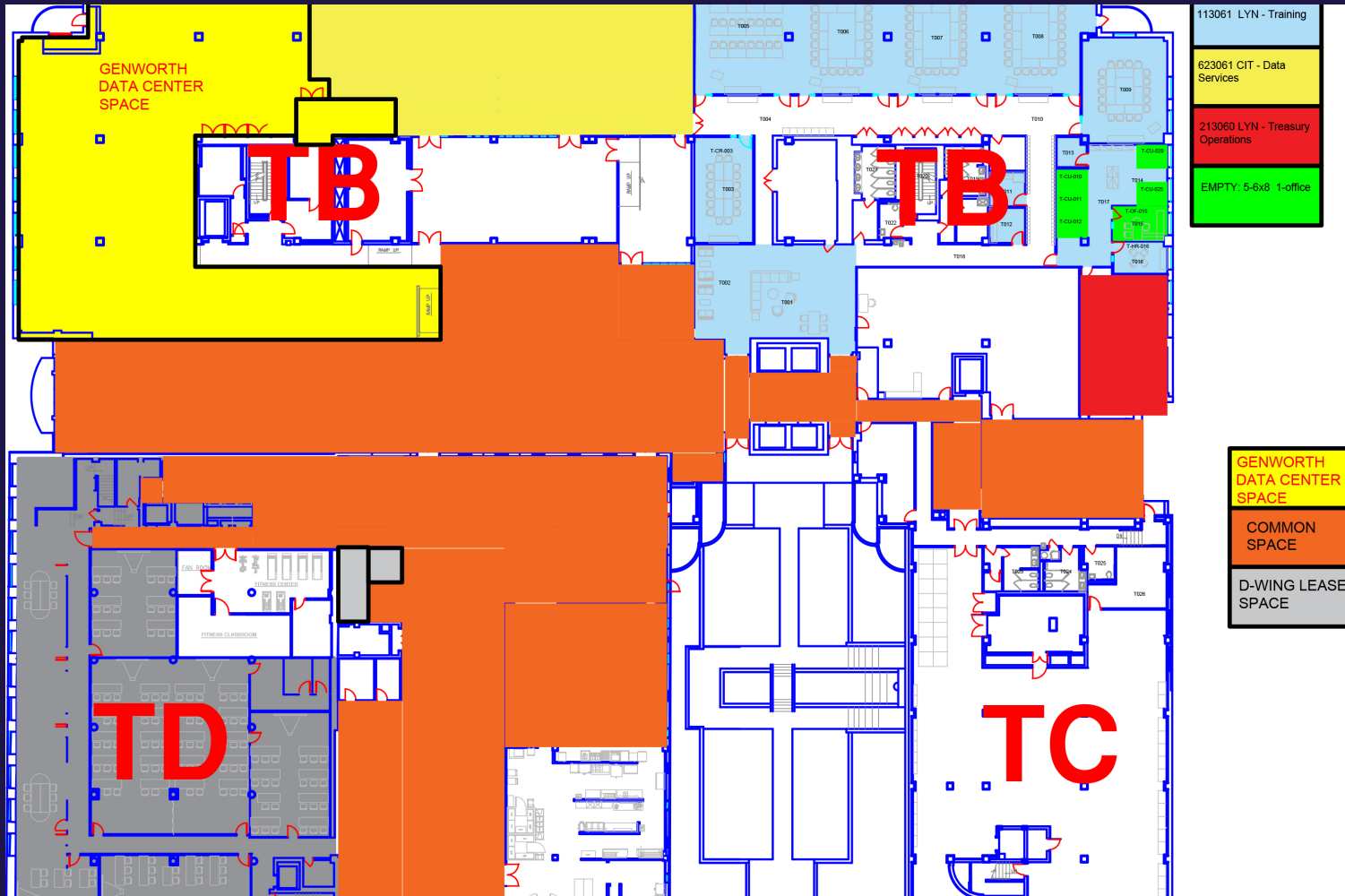

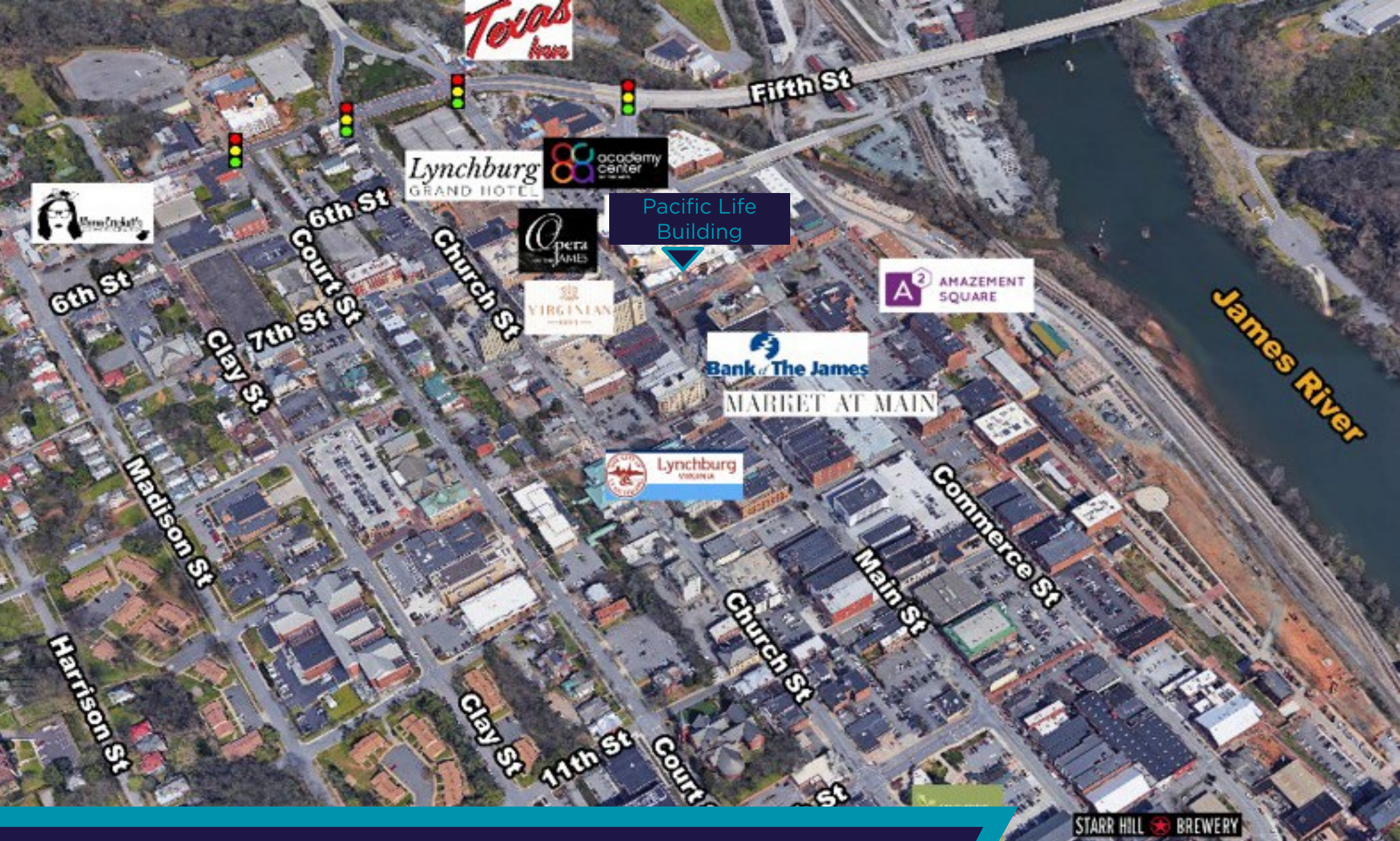

CONTACT:

Norman Moon
First Vice President
434 455 2302
norman.moon@thalhimer.com

Coffee Crossing
6000 Boonsboro Road, Suite A
Lynchburg, VA 24503
thalhimer.com

Independently Owned and Operated / A Member of the Cushman & Wakefield Alliance

Cushman & Wakefield | Thalhimer © 2025. No warranty or representation, express or implied, is made to the accuracy or completeness of the information contained herein, and same is submitted subject to errors, omissions, change of price, rental or other conditions, withdrawal without notice, and to any special listing conditions imposed by the property owner(s). As applicable, we make no representation as to the condition of the property (or properties) in question.



CUSHMAN &
WAKEFIELD

THALHIMER