

# CHESAPEAKE SQUARE

4200 Portsmouth Boulevard, Chesapeake, VA

MAJOR REDEVELOPMENT UNDERWAY





# CHESAPEAKE SQUARE

4200 Portsmouth Boulevard, Chesapeake, VA

## PROPOSED SITE PLAN





# CHESAPEAKE SQUARE

4200 Portsmouth Boulevard, Chesapeake, VA

NEW INVESTMENT IN THE MARKET





# CHESAPEAKE SQUARE

4200 Portsmouth Boulevard, Chesapeake, VA

## FLOOR PLAN

**GROCERY**

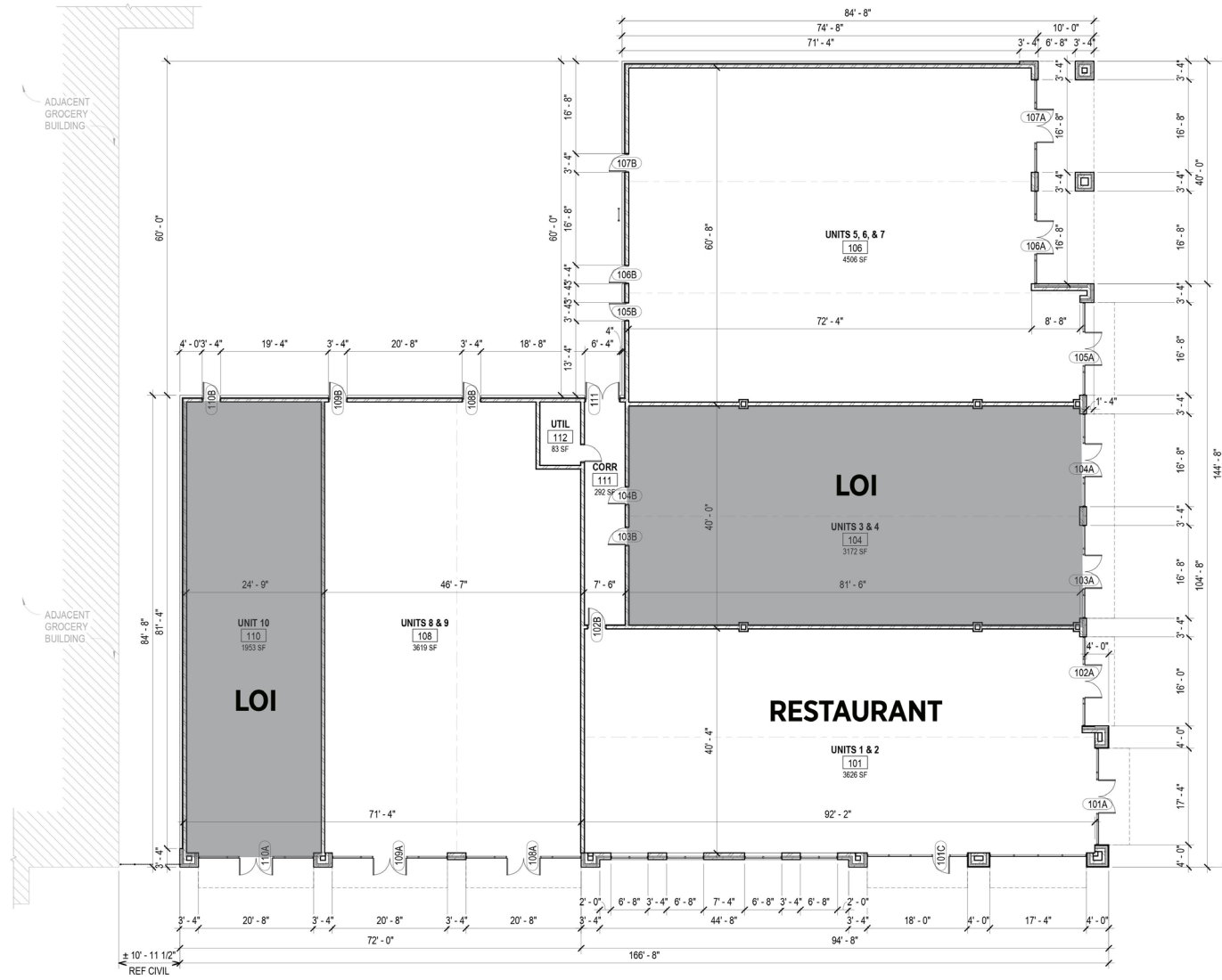

SMALL SHOPS FLOOR PLAN - GROCERY STORE SITE

# CHESAPEAKE SQUARE

4200 Portsmouth Boulevard, Chesapeake, VA

## FLOOR PLAN

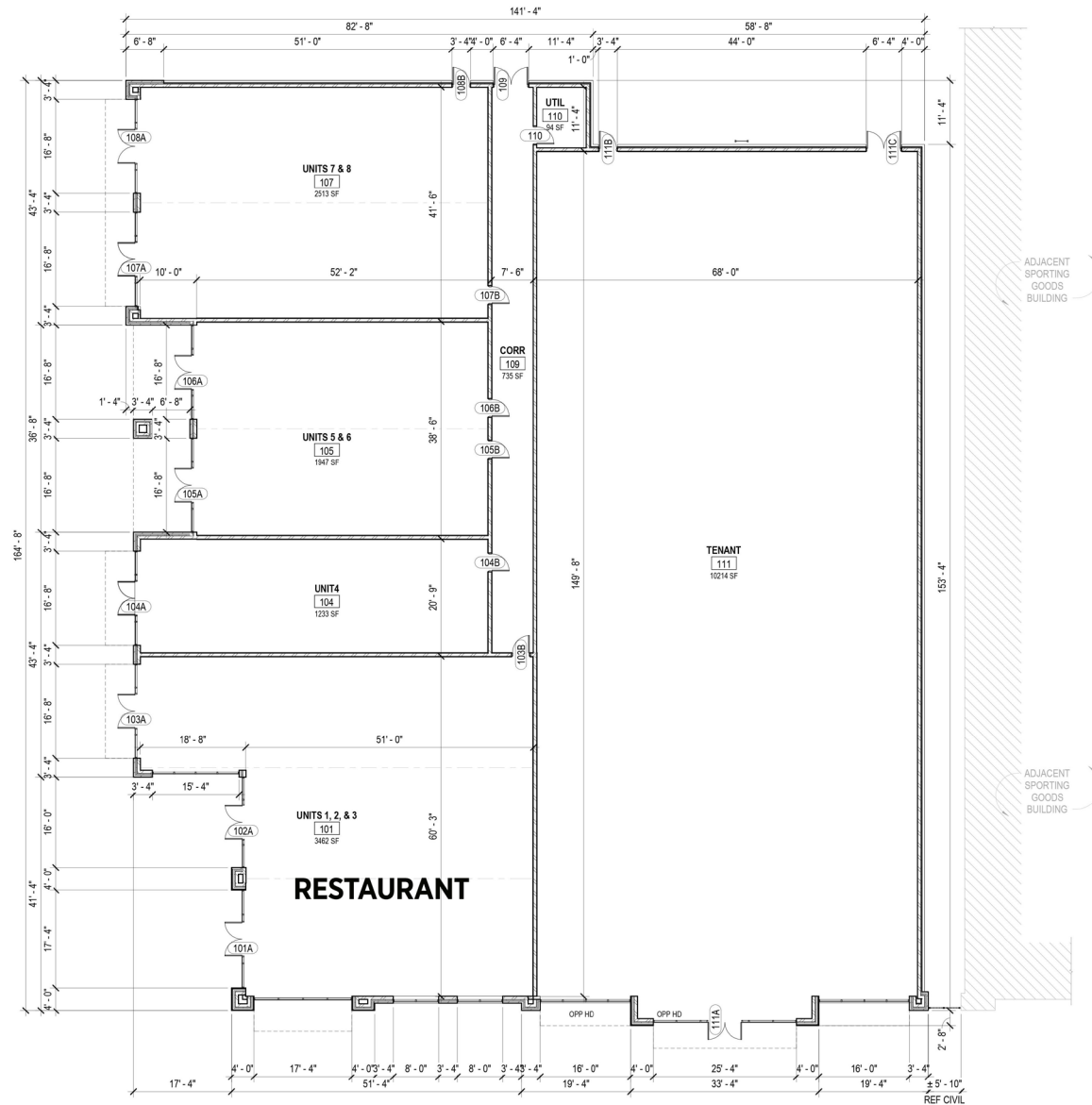

SMALL SHOPS FLOOR PLAN - SPORTING GOODS STORE SITE

# CHESAPEAKE SQUARE

4200 Portsmouth Boulevard, Chesapeake, VA

RESIDENTIAL GROWTH

PREPARED FOR CHESAPEAKE SQUARE MALL  
UPDATED OCTOBER 2023



**2,800+ UNITS** APPROVED OR PERMITTED  
**1,513+ UNITS** DELIVERED

## MAP KEY

APPROVED AND PERMITTED HOUSING

<b>A. Joliff Landing Townhouses</b> 181 Townhouses - 181 Co's	<b>P. White's Landing</b> 6 Single Family Units
<b>B. Homestead @ Bowers Hill Ph1</b> 44 Single Family Units	<b>Q. Waggoner Landing</b> 20 Single Family Units
<b>C. Meadowlake Farms</b> 75 Single Family Units - 62 Co's	<b>R. Walker's Bend on the Elizabeth</b> 23 Single Family Units - 21 Co's
<b>D. Elizabeth Place</b> 12 Single Family Units - 11 Co's	<b>S. Homestead @ Bowers Hill Ph3</b> 25 Single Family Units
<b>E. Clairmont at Joliff</b> 304 Apartment Units - Completed	<b>T. Homestead @ Bowers Hill PH2</b> 20 Single Family Units
<b>F. Regal Landing</b> 8 Single Family Units - 4 Co's	<b>U. Sweeter Homes, LLC</b> 4 Single Family Units
<b>G. Martins Point</b> 35 Single Family Units - 15 Co's	<b>V. Bradshaw Harbor</b> 21 Single Family Units
<b>H. Monarch Walk Parcel B</b> 71 Condo Units - 62 Co's	<b>W. Townhouse at Joliff Landing</b> 105 Townhouses - 105 Co's
<b>I. Riley Estates</b> 3 Single Family Units	<b>X. Poplar Hill Estates</b> 24 Single Family Units - 18 Co's
<b>J. Woodlands at Western Branch</b> 136 Condo Units - 136 Co's	<b>Y. Bell Manor Estates</b> 13 Single Family Units - 11 Co's
<b>K. Joliff Landing at WB</b> 424 Single Family Units - 50 Co's	<b>Z. The Cove</b> 71 Townhomes
<b>L. King's Pointe</b> 430 Condo Units - 430 Co's	<b>AA. The Grove</b> 824 Units
<b>M. Reserve at Western Branch</b> 71 Single Family Units - 70 Co's	<b>BB. Drum Creek Farms</b> 19 Units - 15 Co's
<b>N. Smith Farm</b> 64 Single Family Units	<b>CC. Silverwood Forest Condos</b> 24 Units
<b>O. Tuttles Landing</b> 7 Single Family Units - 5 Co's	<b>DD. The Retreat at Western Branch</b> 84 Units - 13 Co's



**800+ UNITS** IN PLANNING STAGES



\$100,194 AVERAGE HOUSEHOLD  
INCOME WITHIN 1 MILE



214,373 ESTIMATED POPULATION  
WITHIN TRADE AREA

# CHESAPEAKE SQUARE

4200 Portsmouth Boulevard, Chesapeake, VA

## HAMPTON ROADS FORECASTED GROWTH

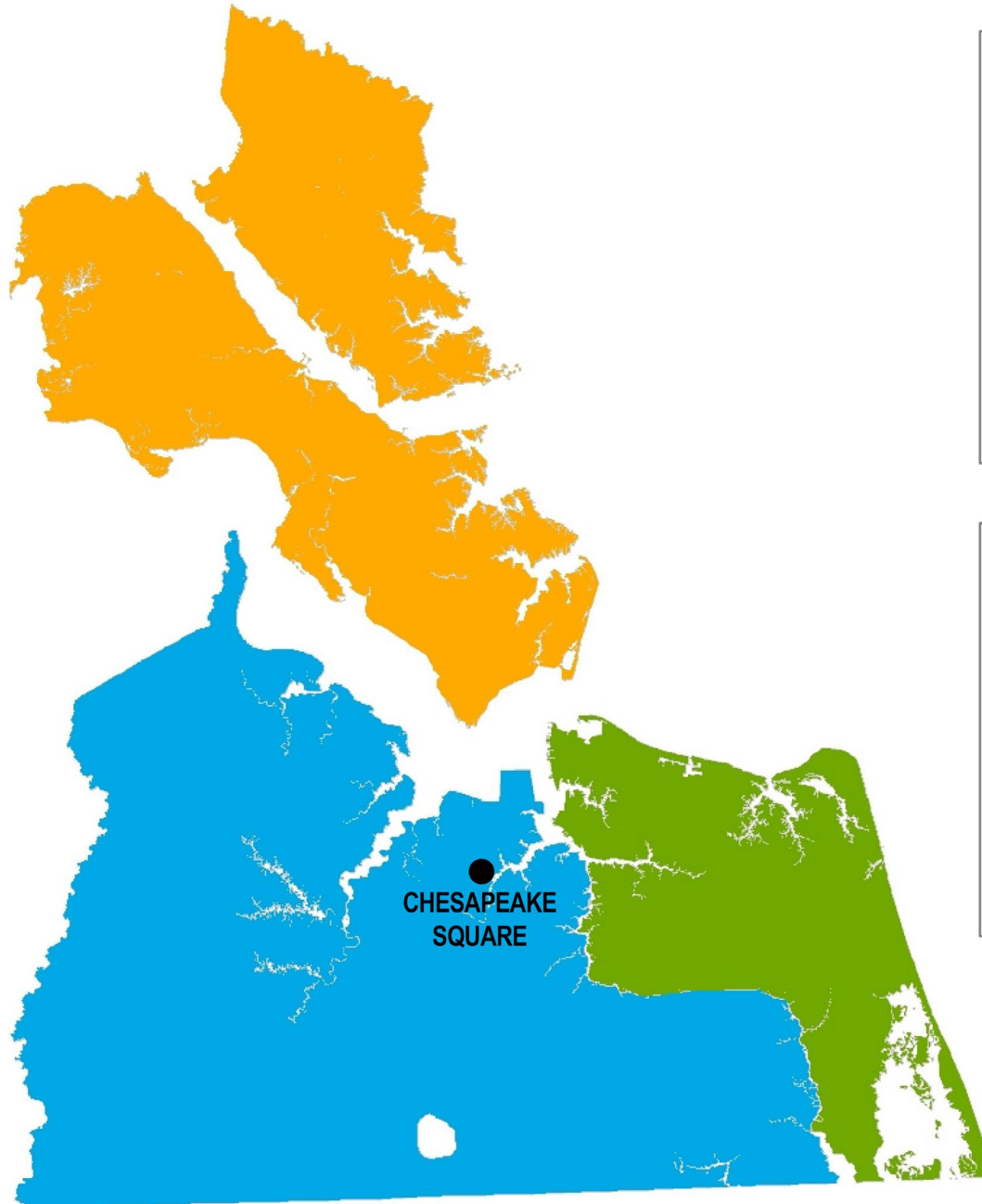

Portion of Population Growth  
2009 to 2040

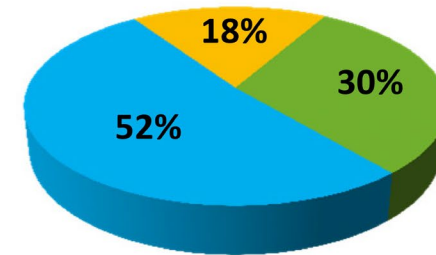

Portion of Total Employment Growth  
2009 to 2040

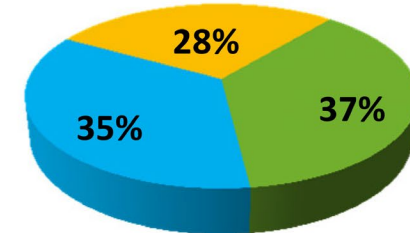



# 4200 Portsmouth Boulevard, Chesapeake, VA





# CHESAPEAKE SQUARE

4200 Portsmouth Boulevard, Chesapeake, VA

## DEMOGRAPHICS



**60,353**

3 MILE POPULATION



**51,386**

3 MILE DAYTIME POPULATION



**39.9**

3 MILE MEDIAN AGE



**\$98,749**

3 MILE AVG HOUSEHOLD INCOME



**2.8M**

VISITS MAR 2022 - FEB 2023



**518K**

CUSTOMERS

### DEMOGRAPHICS

	1 Mile	3 Miles	5 Miles	Trade Area
Est. Population	6,614	60,353	146,690	49,015
Est. Average Household Income	\$105,796	\$98,749	\$95,068	\$110,361
Est. Daytime Population	7,744	51,386	140,051	41,373

### Chesapeake Square 3 Miles

### Norfolk-Portsmouth- Newport News VA MSA

Est. Population	63,739	1,994,378
Est. Average Household Income	\$97,059	\$98,283
Est. Median Household Income	\$75,028	\$72,366
Est. Median Home Value	\$287,759	\$295,565
Est. Median Age	38.8	38.4



# CHESAPEAKE SQUARE

4200 Portsmouth Boulevard, Chesapeake, VA

NEW CITY ROAD BEAUTIFICATION

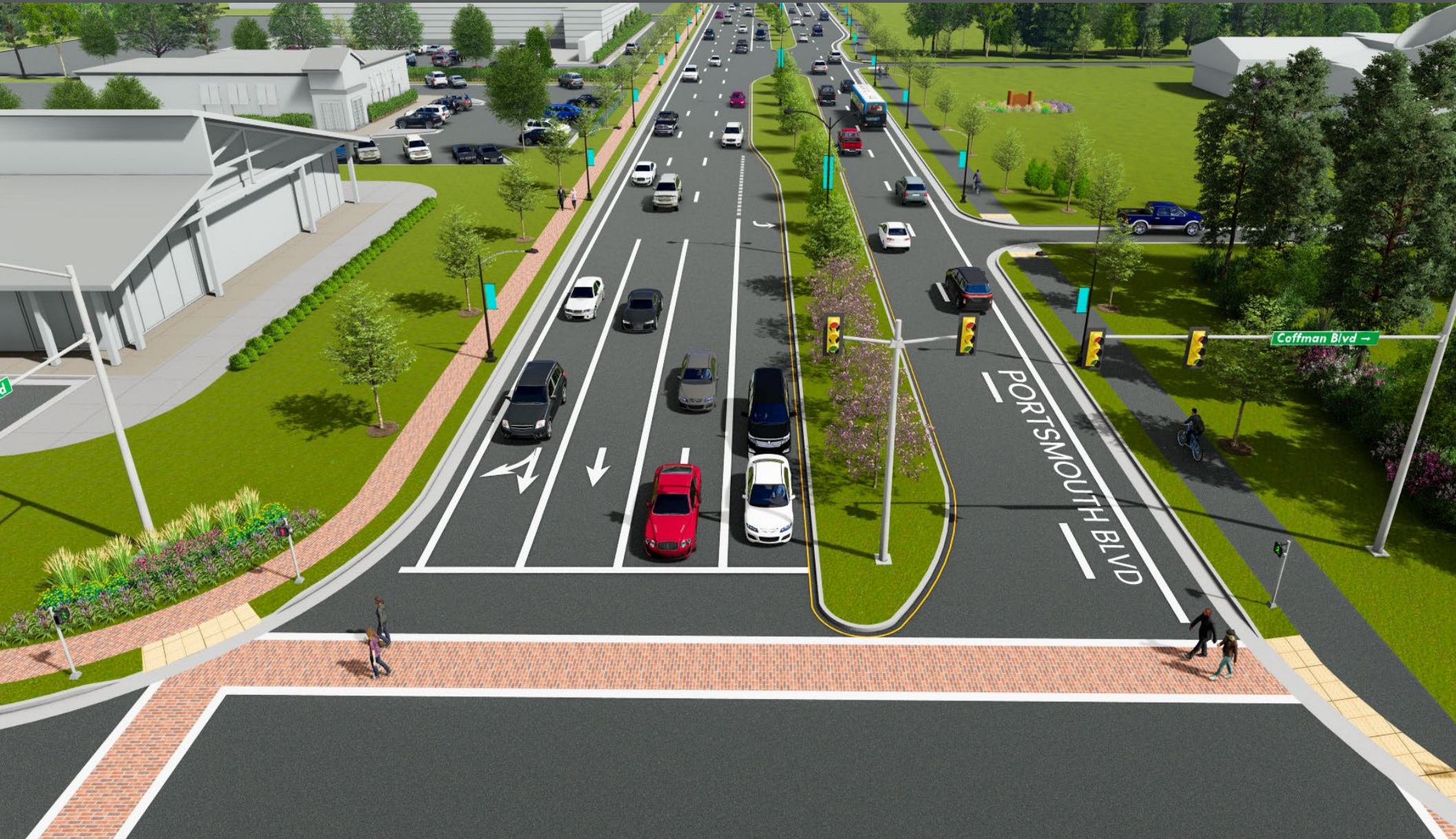



# CHESAPEAKE SQUARE

4200 Portsmouth Boulevard, Chesapeake, VA

NEW ENTRANCES & STREET SCAPING



**DAVID MACHUPA**  
Senior Vice President  
david.machupa@thalhimer.com  
757 213 4156

**ERIC STANLEY**  
First Vice President  
eric.stanley@thalhimer.com  
757 499 2739

Town Center of Virginia Beach  
222 Central Park Avenue, Suite 1500  
Virginia Beach, VA 23462  
thalhimer.com



Independently Owned and Operated / A Member of the Cushman & Wakefield Alliance

Cushman & Wakefield | Thalhimer © 2025. No warranty or representation, express or implied, is made to the accuracy or completeness of the information contained herein, and same is submitted subject to errors, omissions, change of price, rental or other conditions, withdrawal without notice, and to any special listing conditions imposed by the property owner(s). As applicable, we make no representation as to the condition of the property (or properties) in question.