



FLEX SPACE FOR LEASE 900 – 1,800 SF

**3000 – 6000 Incubator Road
Hampton, Virginia 23661**

ELLIS COLTHORPE
Senior Associate
757 818 4307
ellis.colthorpe@thalhimer.com

Peninsula Office
One BayPort Way, Suite 100
Newport News, Virginia 23606
757 873 2900 | [Thalhimer.com](https://www.thalhimer.com)



Independently Owned and Operated / A Member of the Cushman & Wakefield Alliance

Cushman Wakefield | Thalhimer ©2025. No warranty or representation, express or implied, is made to the accuracy or completeness of the information contained herein, and same is submitted subject to errors, omissions, change of price, rental or other conditions, withdrawal without notice, and to any special listing conditions, imposed by the property owner(s). As applicable, we make no representation as to the condition of the property (or properties) in question.

INCUBATOR BUSINESS SUITES

HAMPTON, VIRGINIA 23661

Available Suite:	4000 111 & 112	6000 102	6000 110
Availability:	April 1 st	March 1 st	Immediate
Suite Size:	± 1,800 SF	± 900 SF	± 900 SF
Office Space:	150 SF	150 SF	150 SF
Warehouse Space:	1,650 SF	750 SF	750 SF
Grade-level Loading:	2 12' (w) x 14' (h)	12' (w) x 14' (h)	12' (w) x 14' (h)
Ceiling Height:	15' – 17'	15' – 17'	15' – 17'
LEASE RATE	\$2,100.00 / mo. MG	\$1,100.00 / mo. MG	\$1,100.00 / mo. MG

All Suites:

Zoning: M-3, Heavy Industrial

Tenant Responsible for Electric and Telecom

Landlord Responsible for Water | Sewer and Dumpster Service

FLOORPLANS

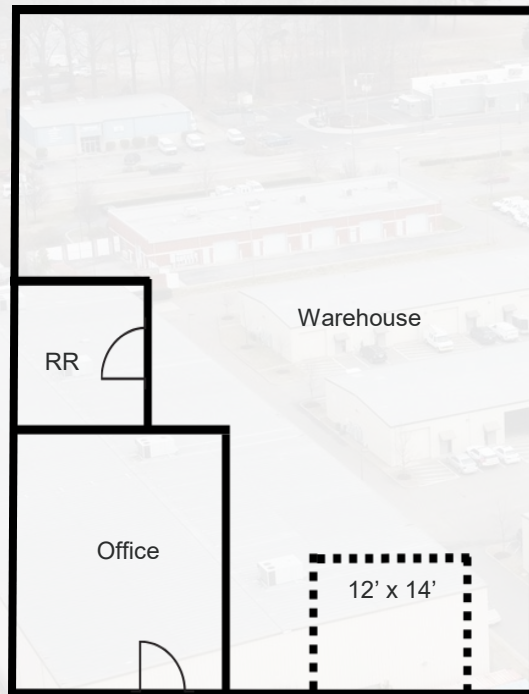

6000 | 102
900 SF

6000 | 110
900 SF

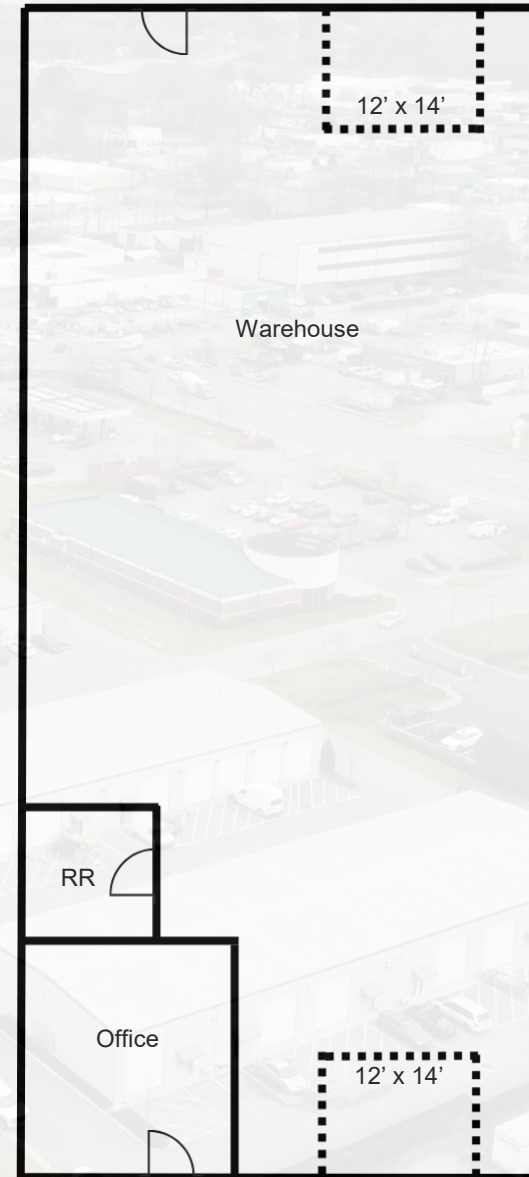

4000 | 111 & 112
1,800 SF

** Not To Scale

6000 INCUBATOR 102 & 110





FLEX SPACE FOR LEASE 900 – 1,800 SF

**3000 – 6000 Incubator Road
Hampton, Virginia 23661**

ELLIS COLTHORPE

Senior Associate

757 818 4307

ellis.colthorpe@thalhimer.com

Peninsula Office

One BayPort Way, Suite 100

Newport News, Virginia 23606

757 873 2900 | Thalhimer.com

