

# INDUSTRIAL FOR LEASE

6829 Atmore Drive

Richmond, Virginia 23225



## TWO SPACES AVAILABLE

Midlothian Corridor

ISAAC DEREGIBUS, SIOR  
Senior Vice President  
804 697 3426  
[isaac.deregibus@thalhimer.com](mailto:isaac.deregibus@thalhimer.com)

CRAIG DOUGLAS  
Senior Associate  
804 344 7153  
[craig.douglas@thalhimer.com](mailto:craig.douglas@thalhimer.com)

IMMEDIATE  
AVAILABILITY



CUSHMAN &  
WAKEFIELD

THALHIMER

Thalhimer Center | 11100 W. Broad Street | Glen Allen, VA 23060 | [www.thalhimer.com](http://www.thalhimer.com)



# SUITE A HIGHLIGHTS



**13,500 SF AVAILABLE**  
SUITE A



**ASKING RATE**  
\$9.00 PSF,  
Industrial Gross



**WAREHOUSE:**  
16' Clear Height



## LOADING

Front platform loading -  
2 Roll Up Doors

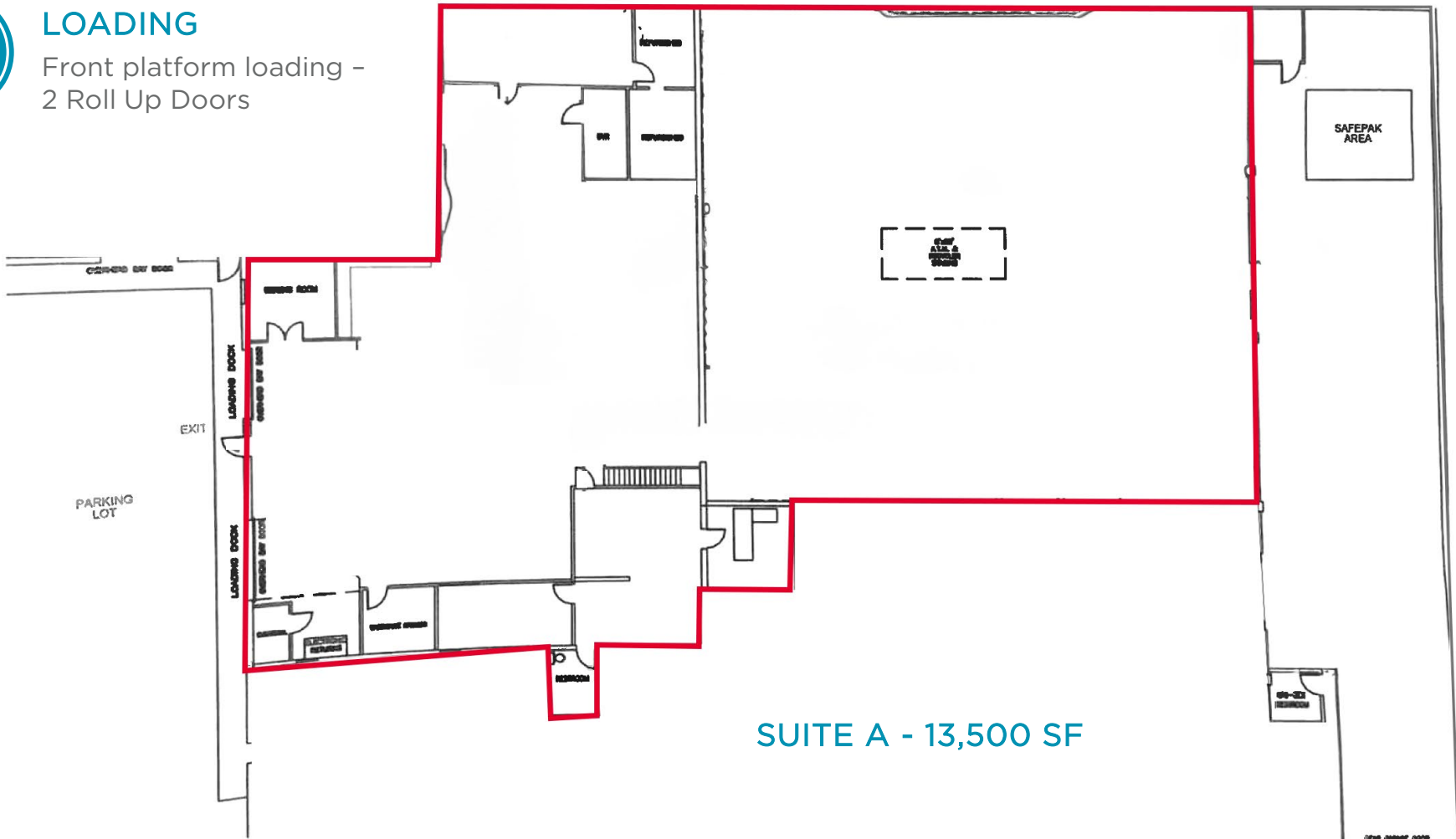



# SUITE A PHOTOS





# SUITE C HIGHLIGHTS



**2,000 SF AVAILABLE**  
SUITE C



**ASKING RATE**  
\$10.00 PSF,  
Industrial Gross



**WAREHOUSE:**  
16' Clear Height



**LOADING**  
Drive in door







**ISAAC DEREGIBUS, SIOR**  
Senior Vice President  
804 697 3426  
[isaac.deregibus@thalhimer.com](mailto:isaac.deregibus@thalhimer.com)

**CRAIG DOUGLAS**  
Senior Associate  
804 344 7153  
[craig.douglas@thalhimer.com](mailto:craig.douglas@thalhimer.com)

Independently Owned and Operated / A Member of the Cushman & Wakefield Alliance

Cushman Wakefield | Thalhimer ©2025. No warranty or representation, express or implied, is made to the accuracy or completeness of the information contained herein, and same is submitted subject to errors, omissions, change of price, rental or other conditions, withdrawal without notice, and to any special listing conditions, imposed by the property owner(s). As applicable, we make no representation as to the condition of the property (or properties) in question.