



+38,580 SF AVAILABLE FOR LEASE

Airport Industrial Park

1431 Baker Road, Virginia Beach, VA 23455



**CUSHMAN &
WAKEFIELD**

THALHIMER

Independently Owned and Operated / A Member of the Cushman & Wakefield Alliance

Cushman & Wakefield | Thalhimer © 2025. No warranty or representation, express or implied, is made to the accuracy or completeness of the information contained herein, and same is submitted subject to errors, omissions, change of price, rental or other conditions, withdrawal without notice, and to any special listing conditions imposed by the property owner(s). As applicable, we make no representation as to the condition of the property (or properties) in question.

1431 BAKER ROAD

Suite C, Virginia Beach, VA 23455



THALHIMER

PROPERTY DETAILS

Available SF:	38,580 SF <ul style="list-style-type: none">• ±4,348 SF Office• 34,232 SF Warehouse	Loading:	One (1) 8'w x 10'h dock with loading platform Four (4) 8'w x 10'h dock doors One (1) 8'w x 10' h drive-in ramp doors
Clear Height:	22'	Zoning:	I-1, Light industrial
Power:	3-phase, 400v, 400 amps	Available:	November 1, 2025
Sprinkler:	Wet system	Asking Rate:	\$8.95 PSF, NNN
Column Spacing:	40' x 50'	OPEX:	\$1.67 PSF



1431 BAKER ROAD

Suite C, Virginia Beach, VA 23455

FLOOR PLAN

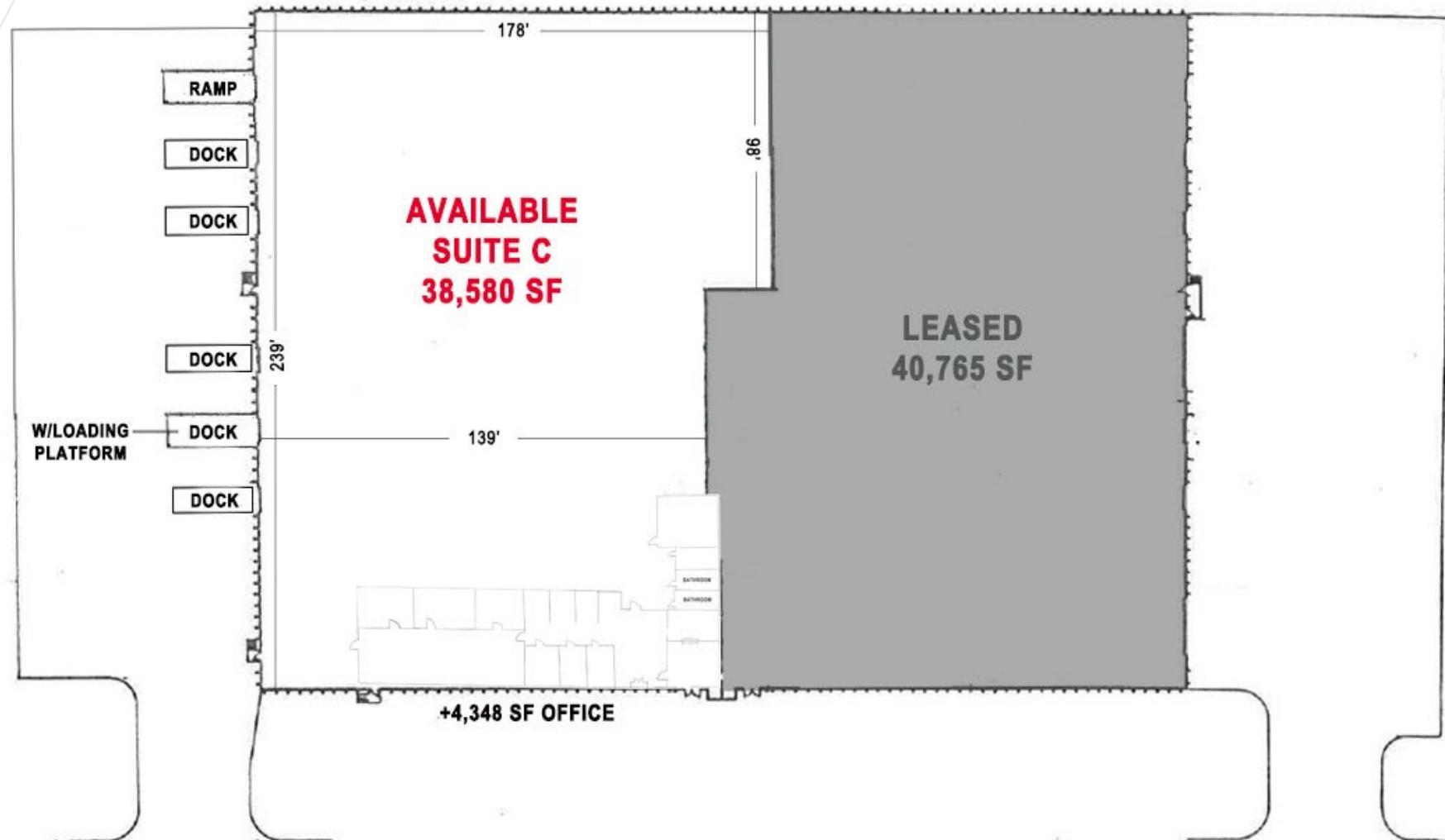



FOR MORE INFORMATION, CONTACT:

GEOFF POSTON, SIOR

Senior Vice President

757 213 4161

geoff.poston@thalhimer.com

CHRISTINE KAEMPFE, SIOR

Senior Vice President

757 499 1384

christine.kaempfe@thalhimer.com

Town Center of Virginia Beach
222 Central Park Avenue, Suite 1500
Virginia Beach, VA 23462
thalhimer.com

Independently Owned and Operated / A Member of the Cushman & Wakefield Alliance

Cushman & Wakefield | Thalhimer © 2025. No warranty or representation, express or implied, is made to the accuracy or completeness of the information contained herein, and same is submitted subject to errors, omissions, change of price, rental or other conditions, withdrawal without notice, and to any special listing conditions imposed by the property owner(s). As applicable, we make no representation as to the condition of the property (or properties) in question.



**CUSHMAN &
WAKEFIELD**

THALHIMER