

**GREAT CENTRAL LOCATION**



**45,000 SF WAREHOUSE FOR LEASE**

**3301 ROSEDALE AVENUE**

**RICHMOND, VIRGINIA 23230**

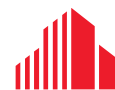

**CUSHMAN &  
WAKEFIELD**

**THALHIMER**



# 3301 ROSEDALE AVENUE

Richmond, Virginia 23230

## PROPERTY Features



### OFFICE/WAREHOUSE

- Exposure to I-95, I-64
- Great central location
- Less than 1 mile to I-95, I-64 & I-195



### LOADING

- 5 Docks
- 1 Drive-In Door



### 45,000 SF

Available Space



### 14'

Ceiling Height



### B-7

Zoning



**3301 ROSEDALE AVENUE**  
**Richmond, Virginia 23230**

# PROPERTY

## Site Plan

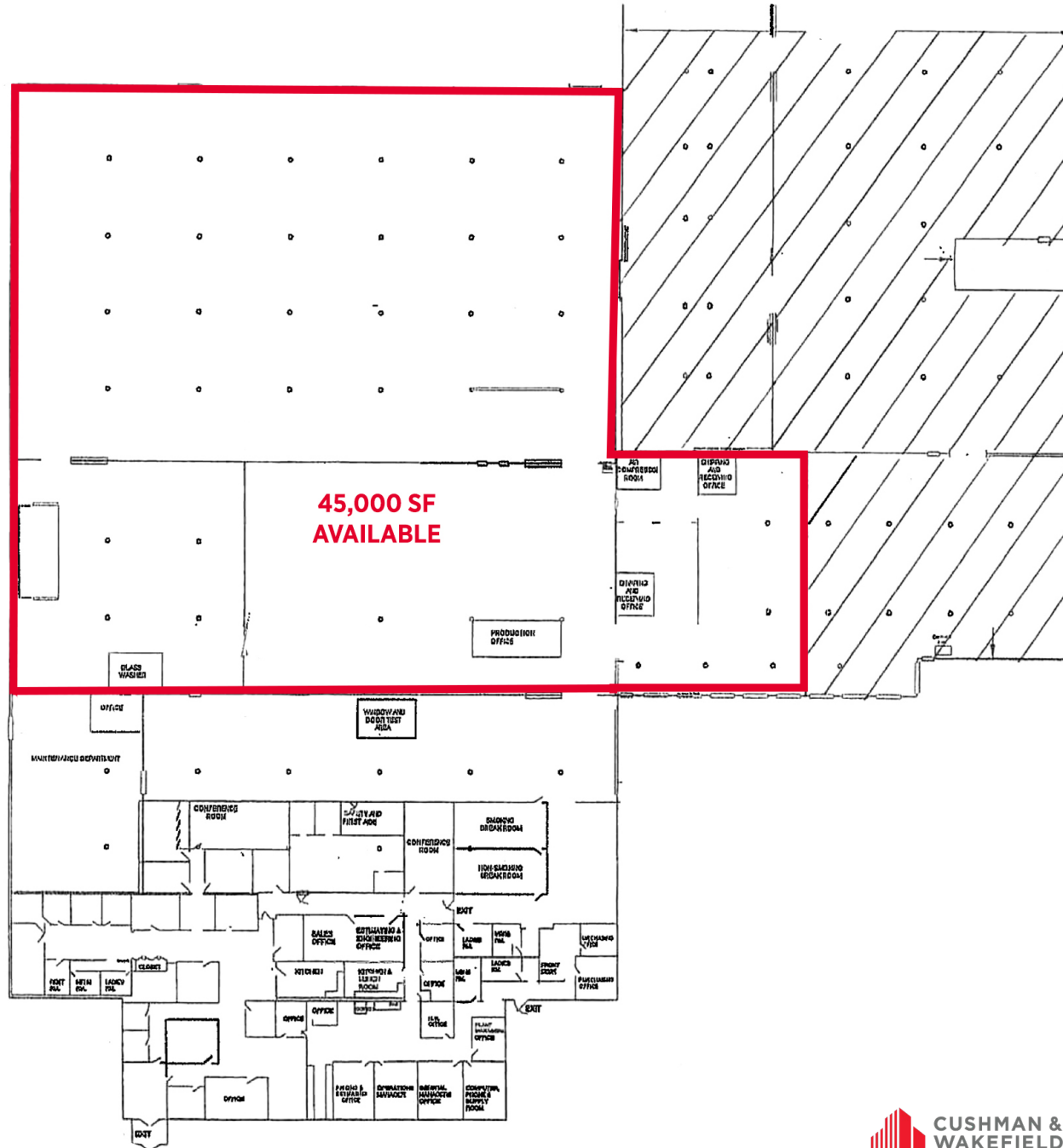





## FOR MORE INFORMATION, CONTACT:

**GRAHAM STONEBURNER, SIOR**  
Senior Vice President  
804 344 7159  
[graham.stoneburner@thalhimer.com](mailto:graham.stoneburner@thalhimer.com)

**CRAIG DOUGLAS**  
Senior Associate  
804 344 7153  
[craig.douglas@thalhimer.com](mailto:craig.douglas@thalhimer.com)

Thalhimer Center  
11100 W. Broad Street  
Glen Allen, VA 23060  
[thalhimer.com](http://thalhimer.com)

Independently Owned and Operated / A Member of the Cushman & Wakefield Alliance

Cushman & Wakefield | Thalhimer © 2025. No warranty or representation, express or implied, is made to the accuracy or completeness of the information contained herein, and same is submitted subject to errors, omissions, change of price, rental or other conditions, withdrawal without notice, and to any special listing conditions imposed by the property owner(s). As applicable, we make no representation as to the condition of the property (or properties) in question.



# THALHIMER